



**BOARD OF DIRECTORS**

**METROPOLITAN ATLANTA RAPID TRANSIT AUTHORITY**

**PLANNING AND CAPITAL PROGRAMS COMMITTEE**

**THURSDAY, MARCH 28, 2024**

**ATLANTA, GEORGIA**

**MEETING SUMMARY**

**1. CALL TO ORDER AND ROLL CALL**

Committee Vice-Chair Kathryn Powers called the meeting to order at 9:48 A.M.

**Board Members**

**Present:**

Al Pond  
Freda Hardage  
James Durrett  
Kathryn Powers  
Roderick Frierson  
William Floyd  
Valencia Williamson  
Rita Scott  
Jennifer Ide  
Jacob Tzegaegbe  
Sagirah Jones

**Board Members**

**Absent:**

Stacy Blakley  
Thomas Worthy  
Jannine Miller  
Russell McMurry

**Staff Members Present:**

Collie Greenwood  
Carrie Rocha  
Rhonda Allen  
George Wright  
Gena Major  
Peter Andrews  
Kevin Hurley  
Michael Kreher

**Also in Attendance:** Justice Leah Ward Sears, Phyllis Bryant, Shelandra Cornick, Jacqueline Holland, Kenya Hammond and Tyrene Huff

**2. APPROVAL OF THE MINUTES**

**Planning and Capital Programs Committee Minutes from February 22, 2024**

Approval of the Planning and Capital Program Minutes from February 22, 2024. On a motion by Board Member Pond, seconded by Board Member Ide, the motion passed by a vote of 7 to 0 with 1 member abstaining and 8 members present.

**3. BRIEFING**

**Briefing - Five Points Transformation Project**

Carrie Rocha, Chief Capital Officer, provided the Committee with an overview of the operational impacts of the upcoming Five Points Station Transformation project.

**4. OTHER MATTERS**

General Manager/CEO, Collie Greenwood, briefed the Committee on the Streetcar East Extension project and proposed infill stations along the Atlanta Beltline.

**5. ADJOURNMENT**

The Committee meeting adjourned at 10:26 A.M.

YouTube link: <https://www.youtube.com/live/gWIpN8fX5Vg?feature=shared>



# Five Points Station Transformation Project Briefing

---

Planning & Capital Programs  
Committee

March 28, 2024

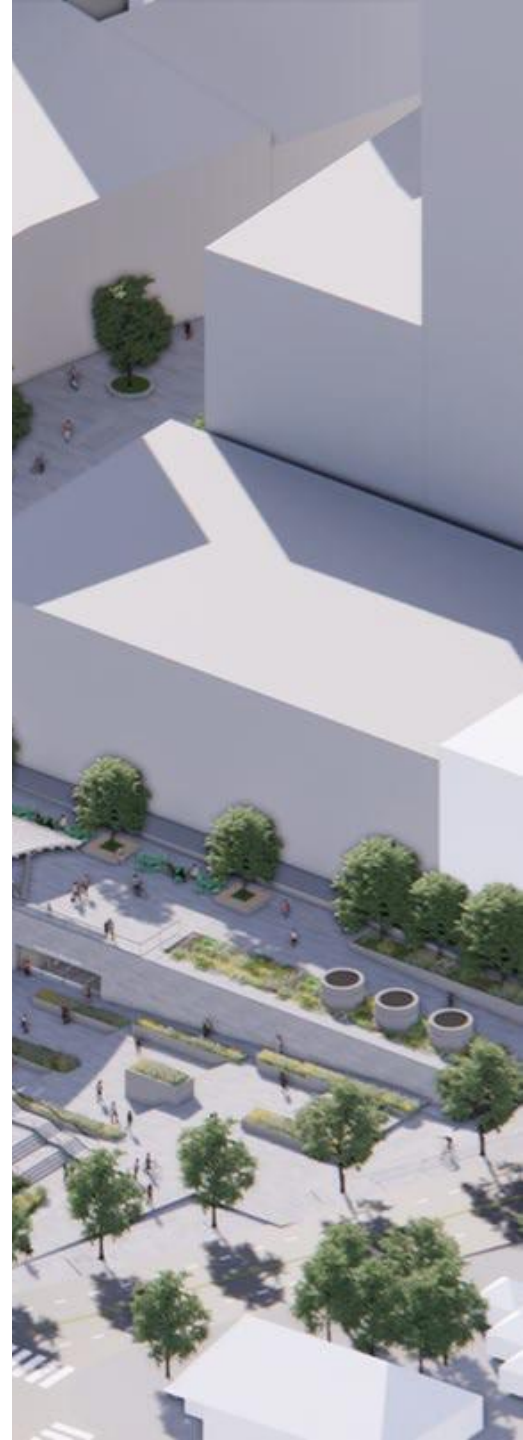

# Briefing Contents

Project Status – Path to Construction Start  
 Construction Impacts to Customers  
 Next Steps

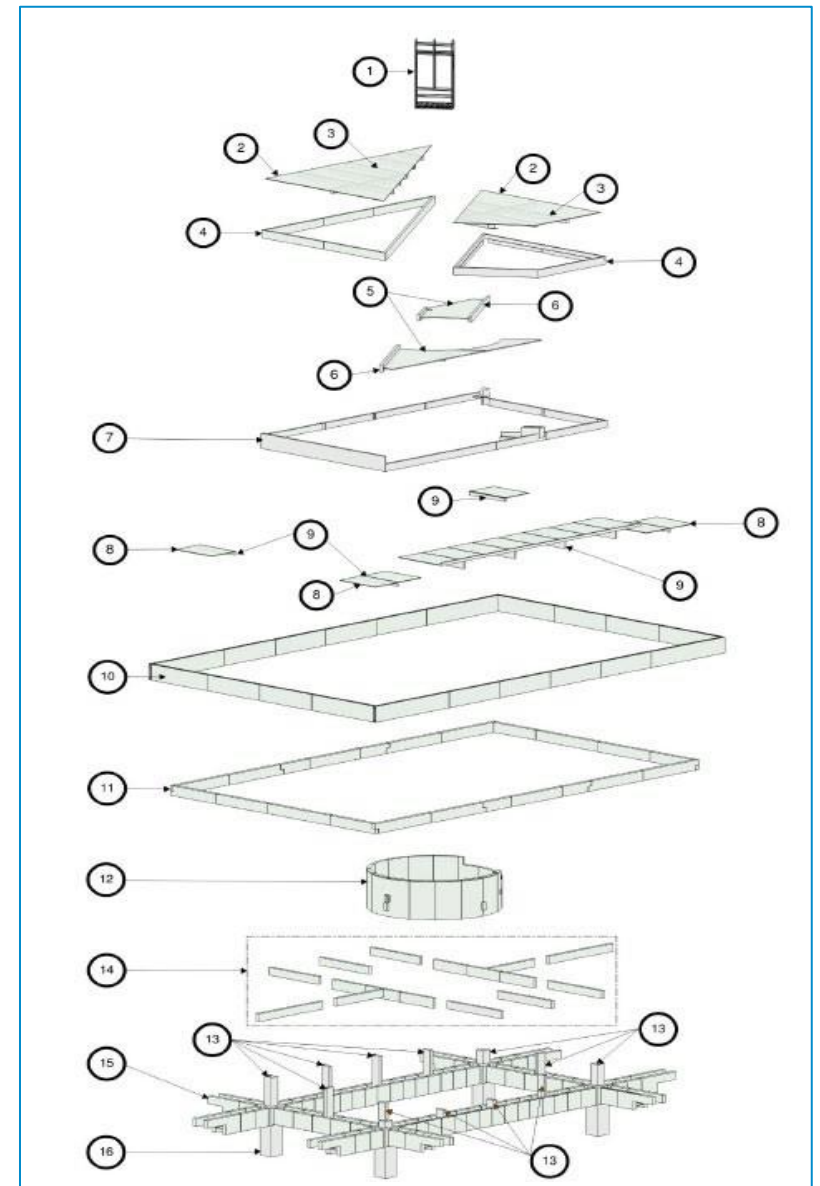



# Project Status – Path to Construction Start

## Completed Activities

- ✓ Memorandum of Agreement (MOA) for Mitigation – 1/9/24
- ✓ Environmental Assessment (EA) Public Comments & Responses – 12/1/23 – 1/5/24
- ✓ Finding of No Significant Impact (FONSI) – 3/25/24
- ✓ Section 4(f) Documentation Completed – 3/25/24
- ✓ Historic American Buildings Survey (HABS) Photography by National Park Service (NPS) – 1/10/24

## In-Progress Activities

- ❑ RAISE Paper Grant Agreement (PGA) to be Signed
- ❑ Site Plans for Accommodations Needed for Temporary Stops
- ❑ Finalize Plans for ADA Access Shuttle
- ❑ Deconstruction & Demolition CGMP Negotiations Complete
- ❑ Board Authorization for Deconstruction & Demolition Contracts

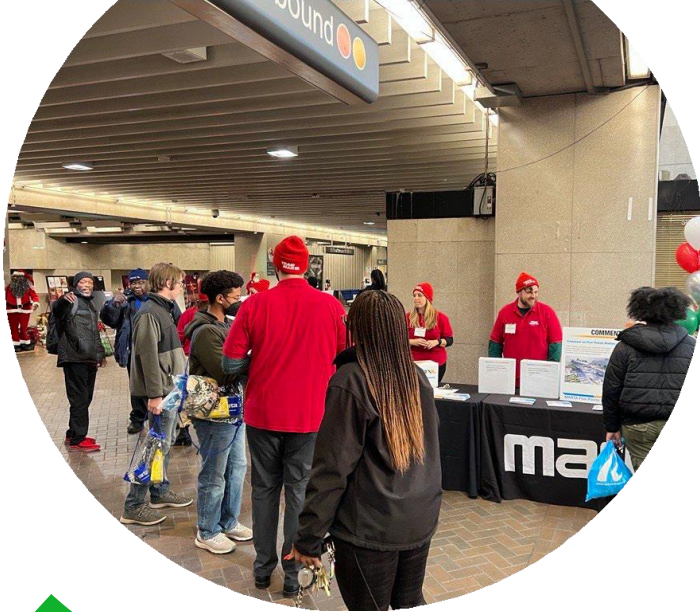







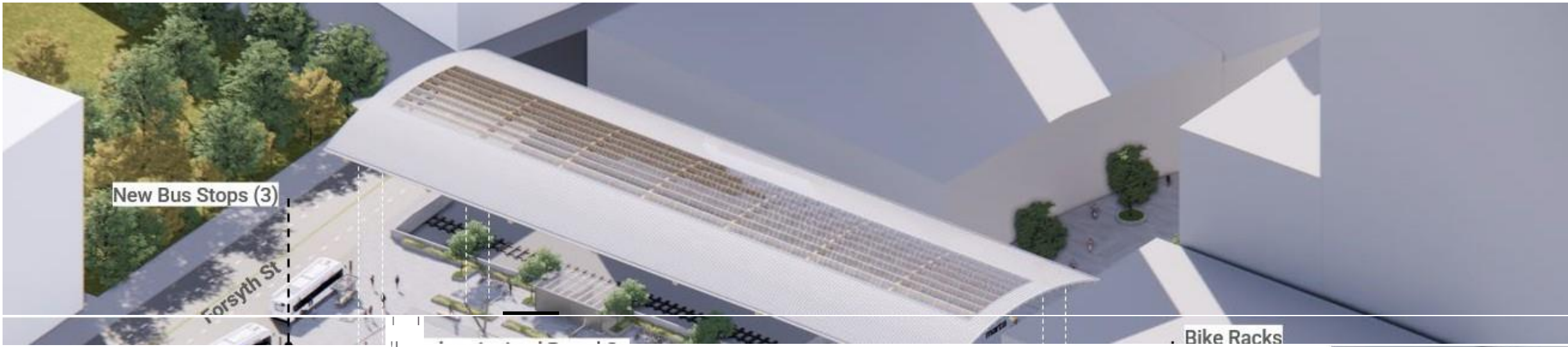



## **Construction Phase Planning**

---

- Minimize disruption to travel patterns by providing continued access to Downtown and nearby stations
- No pedestrian or bus access to Five Points Station
- Rail transfers are possible within the station
- When project is complete, routes should be restored to serve Five Points (as planned through the Bus Network Redesign project)



## Detour Strategies

---



Maintain direct downtown access where possible by continuing through-routing where it already exists



Detour bus routes that terminate and layover at Five Points Station to other nearby stations



Increase capacity at nearby stations by making temporary/tactical transit accommodations (coordinated with City of Atlanta)



Adjust key schedules in April 2024 mark-up to prepare for detours

# Rider Impacts

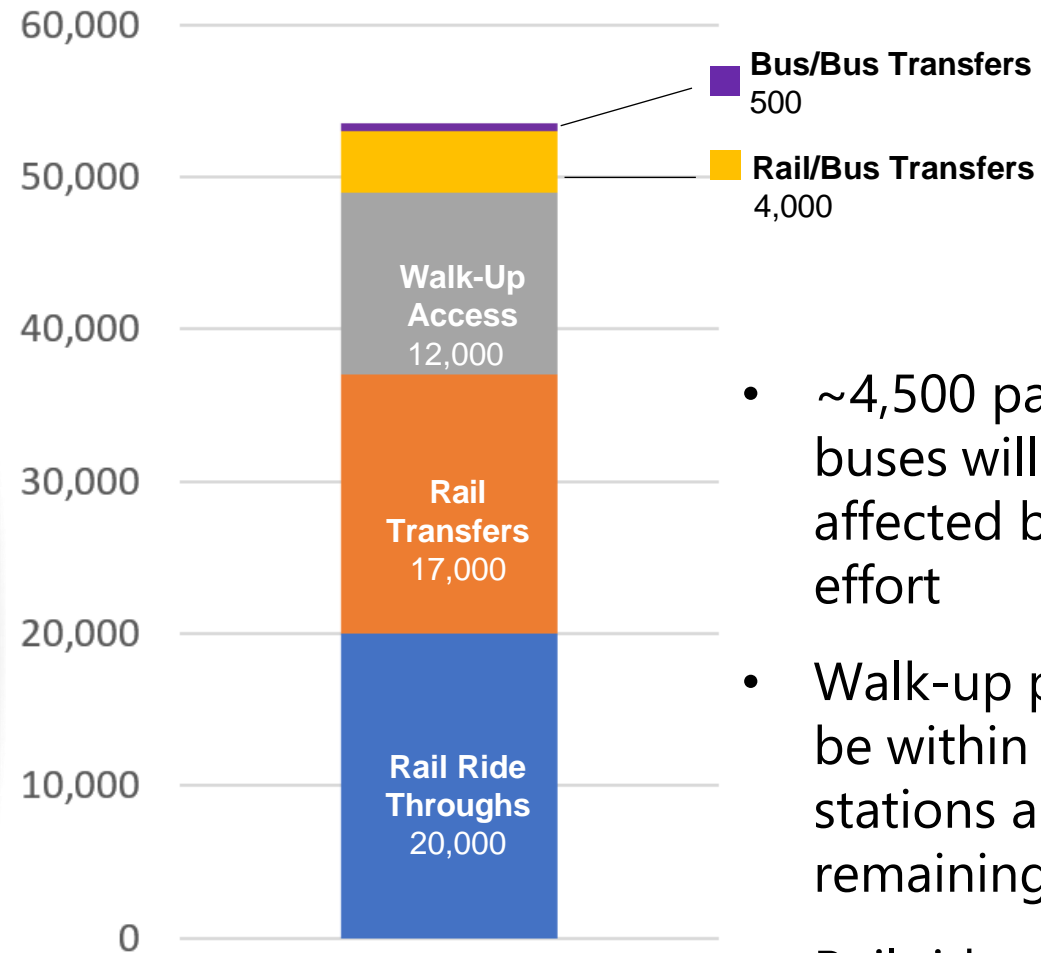

*Five Points Weekday Ridership by Means of Access*

- ~4,500 passengers using buses will be significantly affected by the detour effort
- Walk-up passengers will be within 1/2 mile of other stations and will have remaining bus options
- Rail ride-through passengers and most of those making rail line transfers will not be affected



## Operational Changes & Customer Impacts During Construction

- No pedestrian access at street levels; contractor and emergency access/egress only.
- Concourse Level (faregates) will be closed
  - No patron restrooms; employee restroom near Marble Room on outer East Platform
  - No elevator access from N/S to E/W Platform levels; must ride to adjacent station(s) and return on opposite direction to access other platform
- Transfers for rail service between platforms will not be affected.
- Closure to plaza/concourse is planned for 18 months, duration will be refined as design progresses.
- Accommodations will be made to reopen the plaza/concourse access during the World Cup.
- Construction will continue through 2028.



# Ashby Station Relocation

MARTA Police Central Precinct (west line) – coverage maintained in station ●

Lost and Found ●  
Reduced Fare ●

Ride Store ●  
MARTA HOPE ●

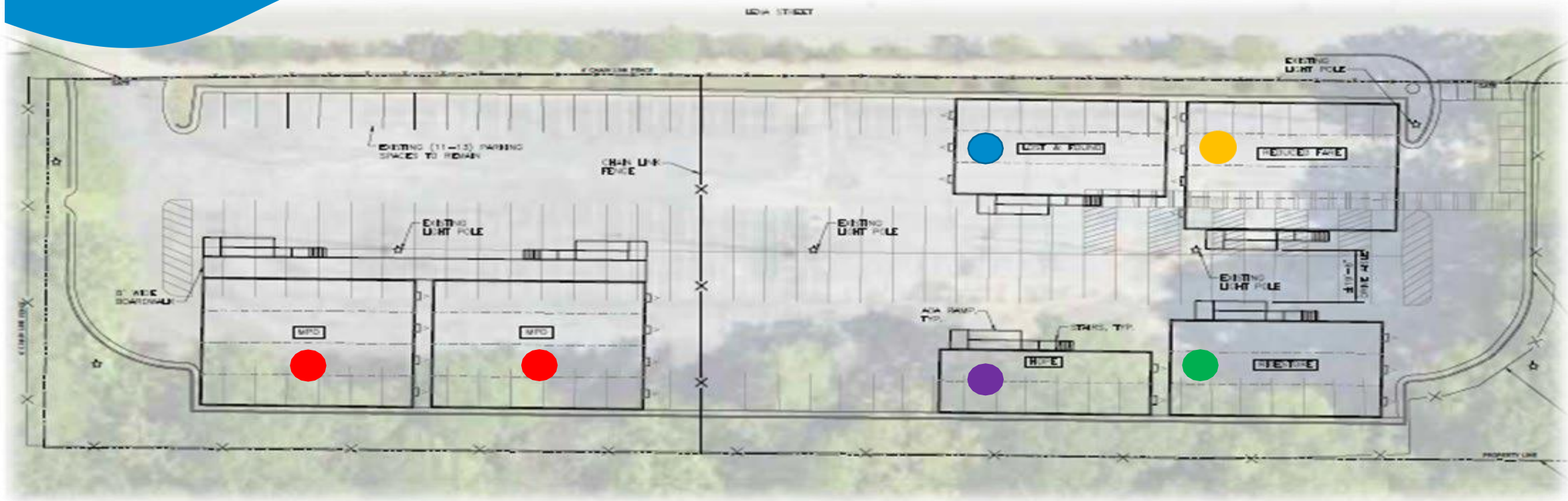



**Closing During  
Construction**

FIVE POINTS FARM

A MARTA MAKEOVER COMMUNITY GARDEN

marta<sup>®</sup>  
market



**Station  
Soccer<sup>®</sup>**  
*Atlanta*

Connecting communities through transit, soccer, and leadership training.

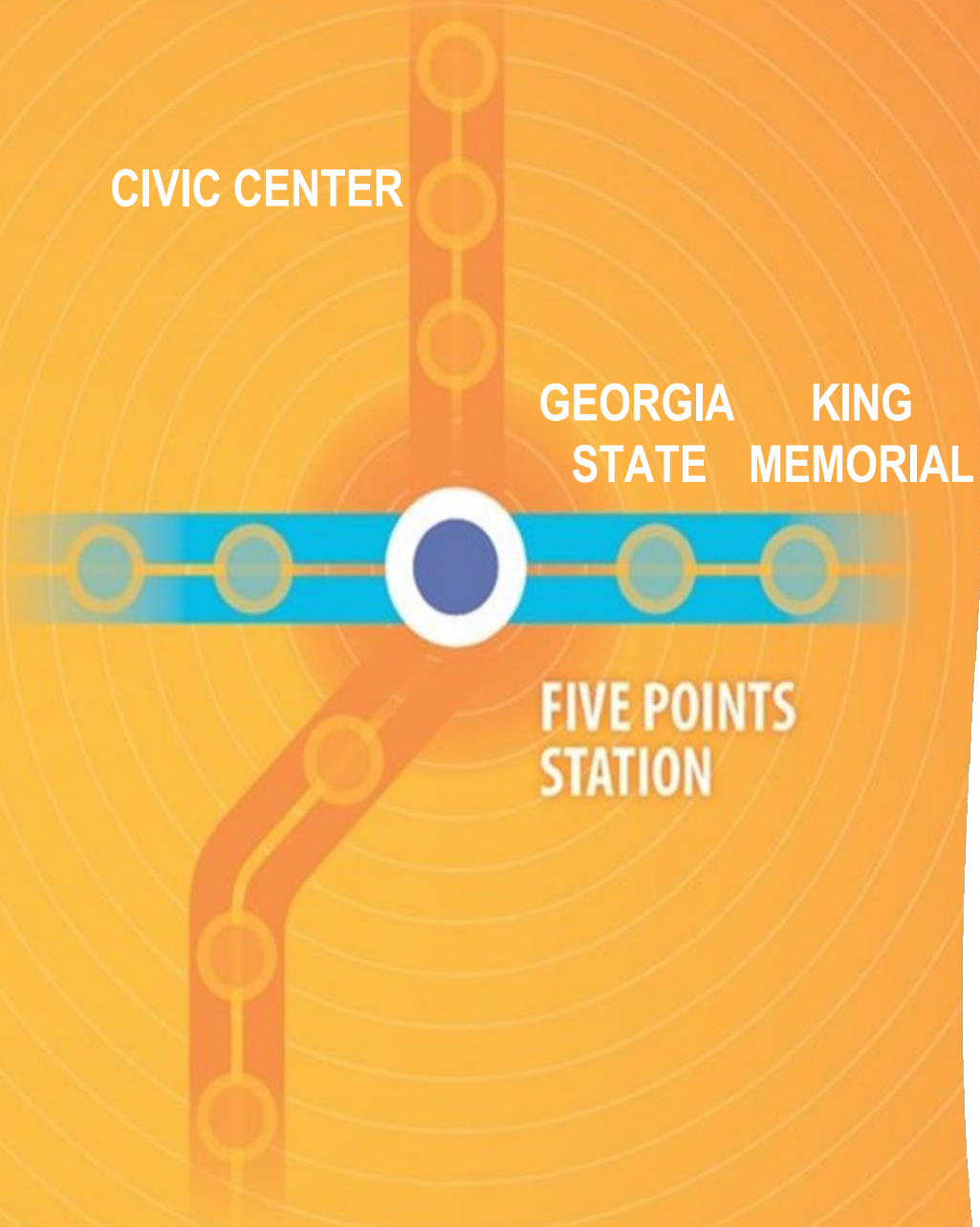

| Rail Station         | Bus Routes Detoured  |
|----------------------|--|
| <b>Georgia State</b> | 21 – Memorial Dr<br>42 – Pryor Rd<br>49 – McDonough Blvd<br>55 – Jonesboro Rd<br>186 – Rainbow Dr/South DeKalb |
| <b>King Memorial</b> | 26 – Marietta St/Perry Blvd<br>899 – Old Fourth Ward   |
| <b>Civic Center</b>  | 816 – North Highland Ave   |

|   |   |
|---|---|
| <b>Through-Routed to Maintain Service in Five Points Area</b> | Route 3 – Martin Luther King Jr Dr/Auburn Ave<br>Route 40 – Peachtree St/ Downtown<br>Route 813 – Atlanta University Center |
|---|---|

# Detour Routes to Georgia State

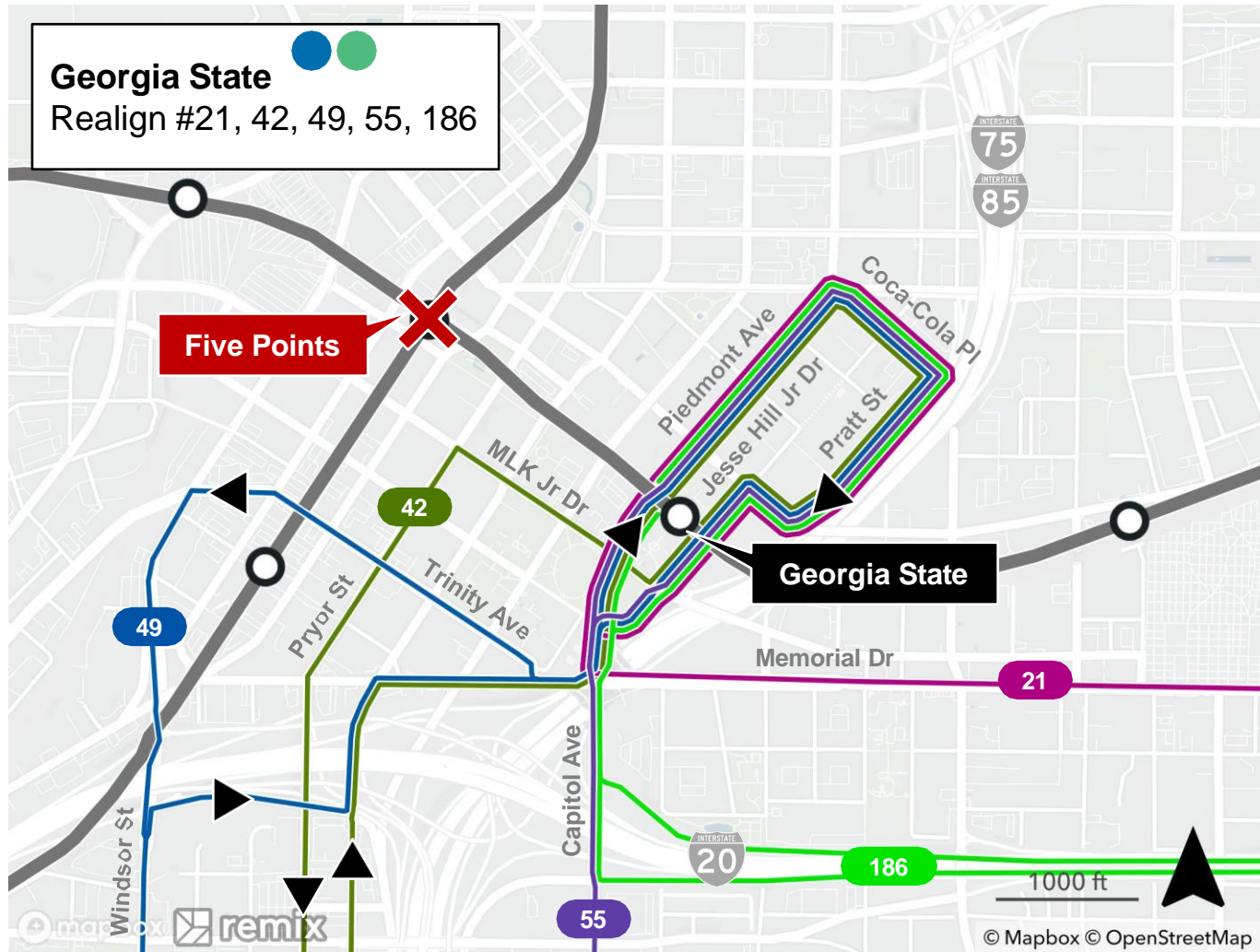

- Realign the following routes to Georgia State Station
  - 21 – Memorial Dr
  - 42 – Pryor Rd
  - 49 – McDonough Blvd
  - 55 – Jonesboro Rd
  - 186 – Rainbow Dr/South DeKalb
- Operational and Customer Experience challenges at the station will be addressed



# Detour Routes to Georgia State

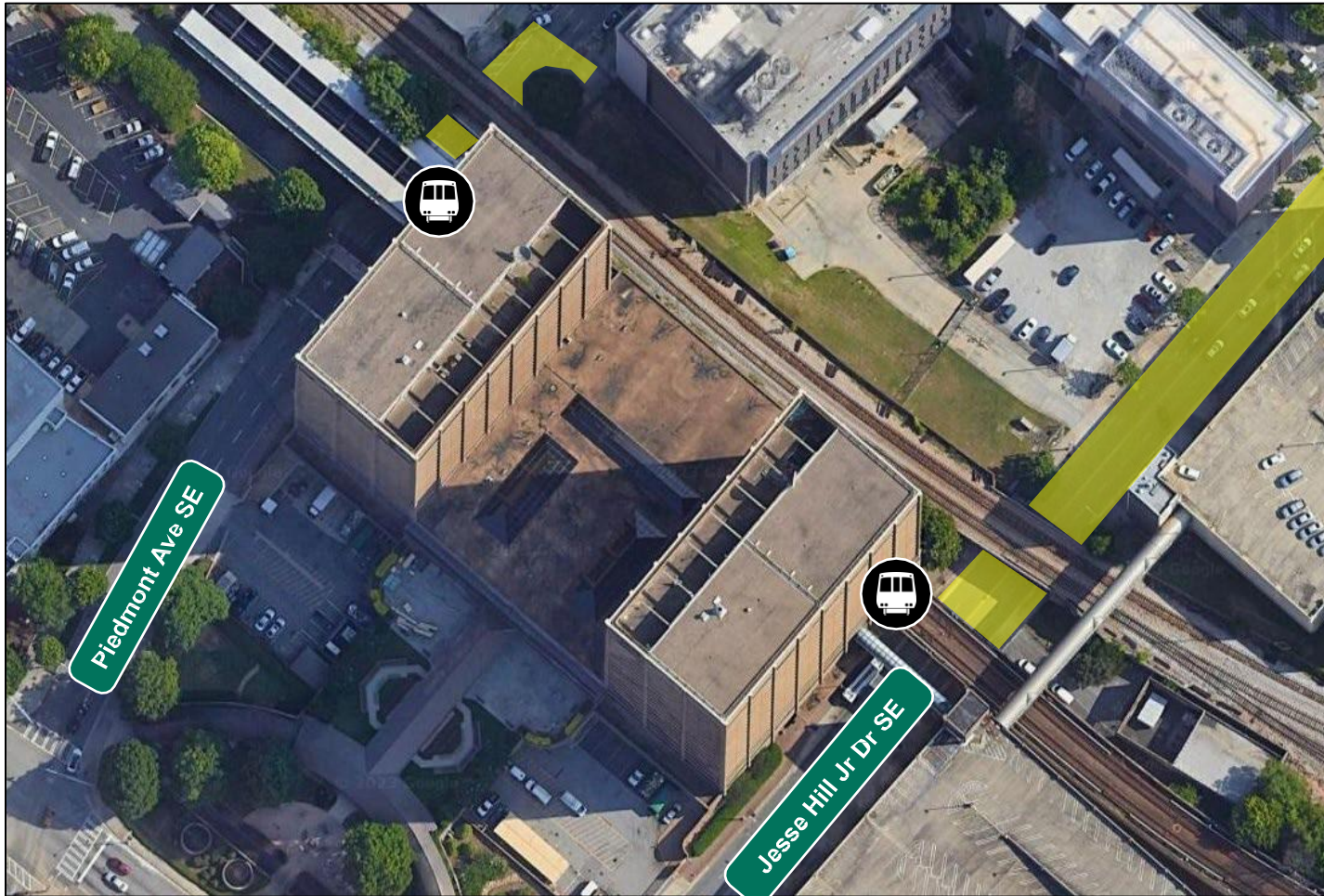

- **Temporary bus stop zones** to be added on Piedmont Ave and Jesse Hill Jr Dr
- Additional layover-only space will be added on Jesse Hill Jr Dr
- On Piedmont Ave, we will be converting no parking areas to **dedicated parking for MARTA fleet vehicles**



Rail station entrance



Detoured bus operations to be relocated to these areas



# Detour Routes to Georgia State On-Street Accommodations

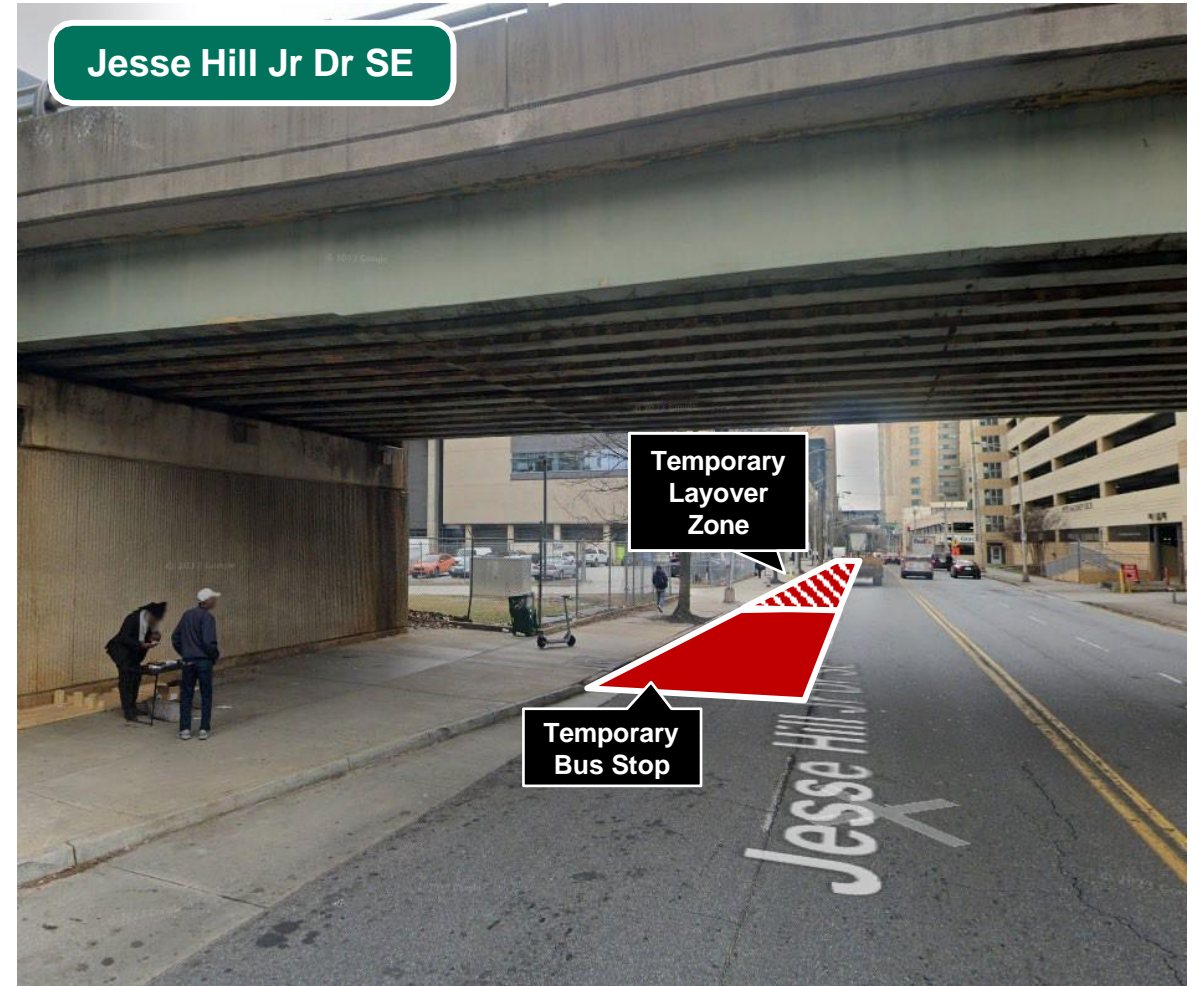
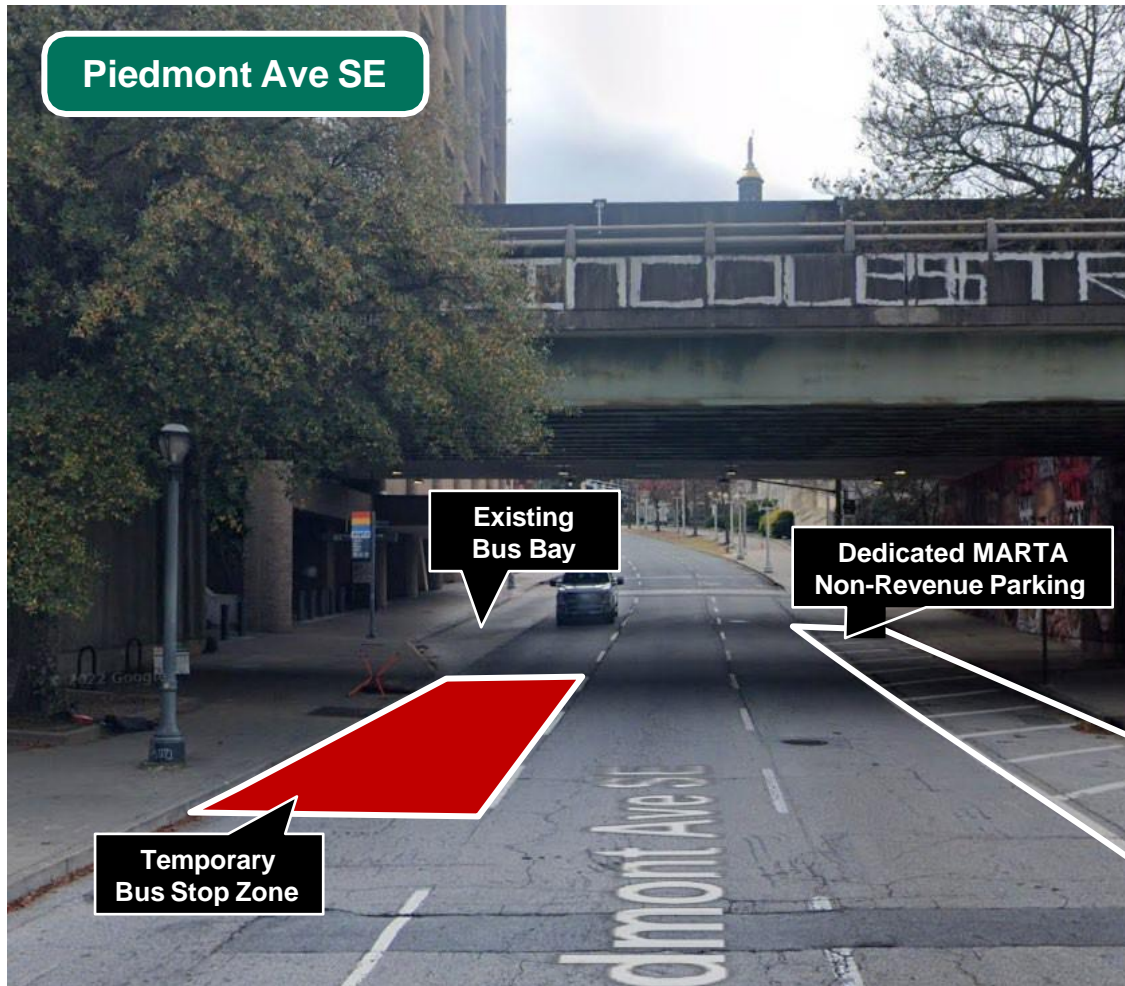



# Detour Routes to Georgia State On-Street Accommodations

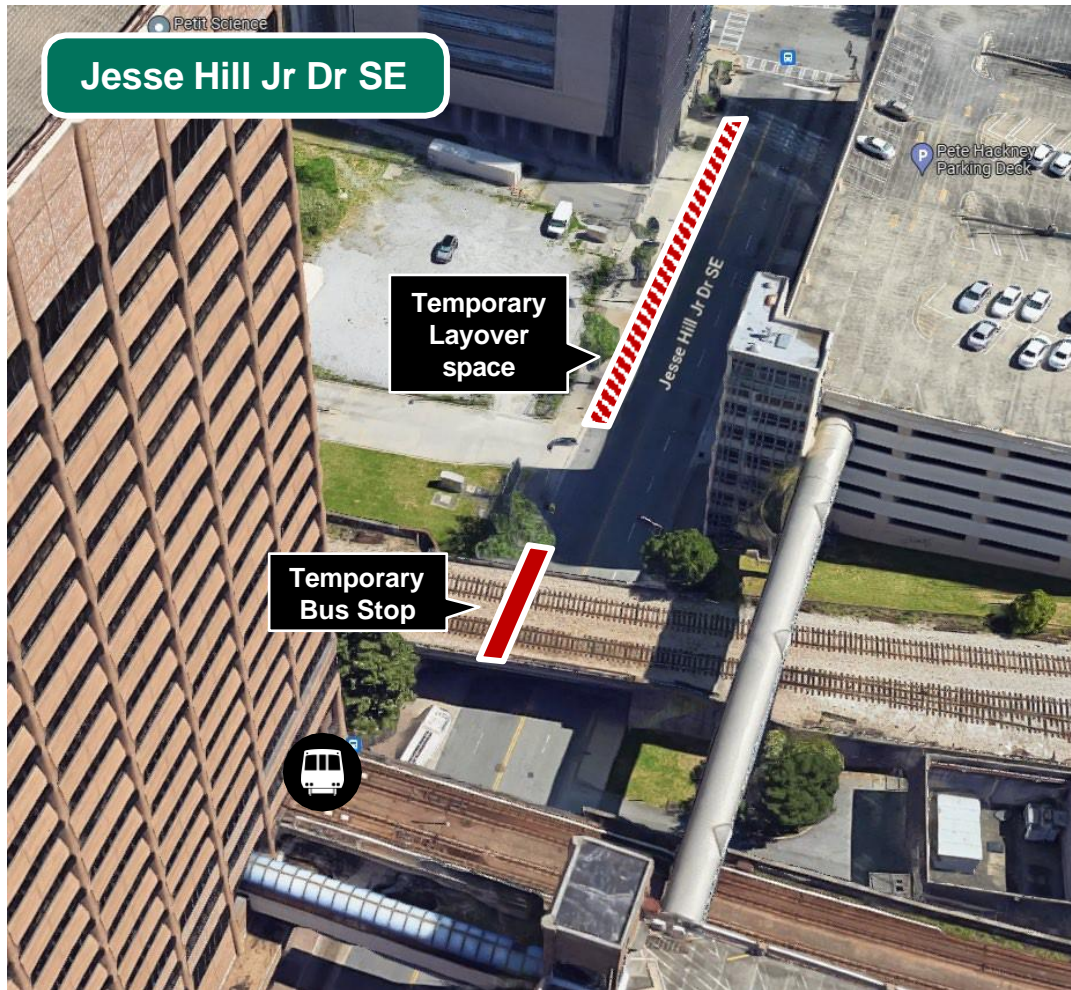

- On Jesse Hill Jr Dr, a **temporary bus stop** to be added under the freight railroad bridge
- Additional **layover-only space** to be established along Jesse Hill Jr Dr, clear of the GSU Petit Science Center service driveway



Rail station entrance

# Detour Routes to King Memorial



- Realign the following routes to King Memorial Station
  - 26 – Marietta St/Perry Blvd
  - 899 – Old Fourth Ward
- Does not require additional on-street accommodations

# Detour Service to Civic Center

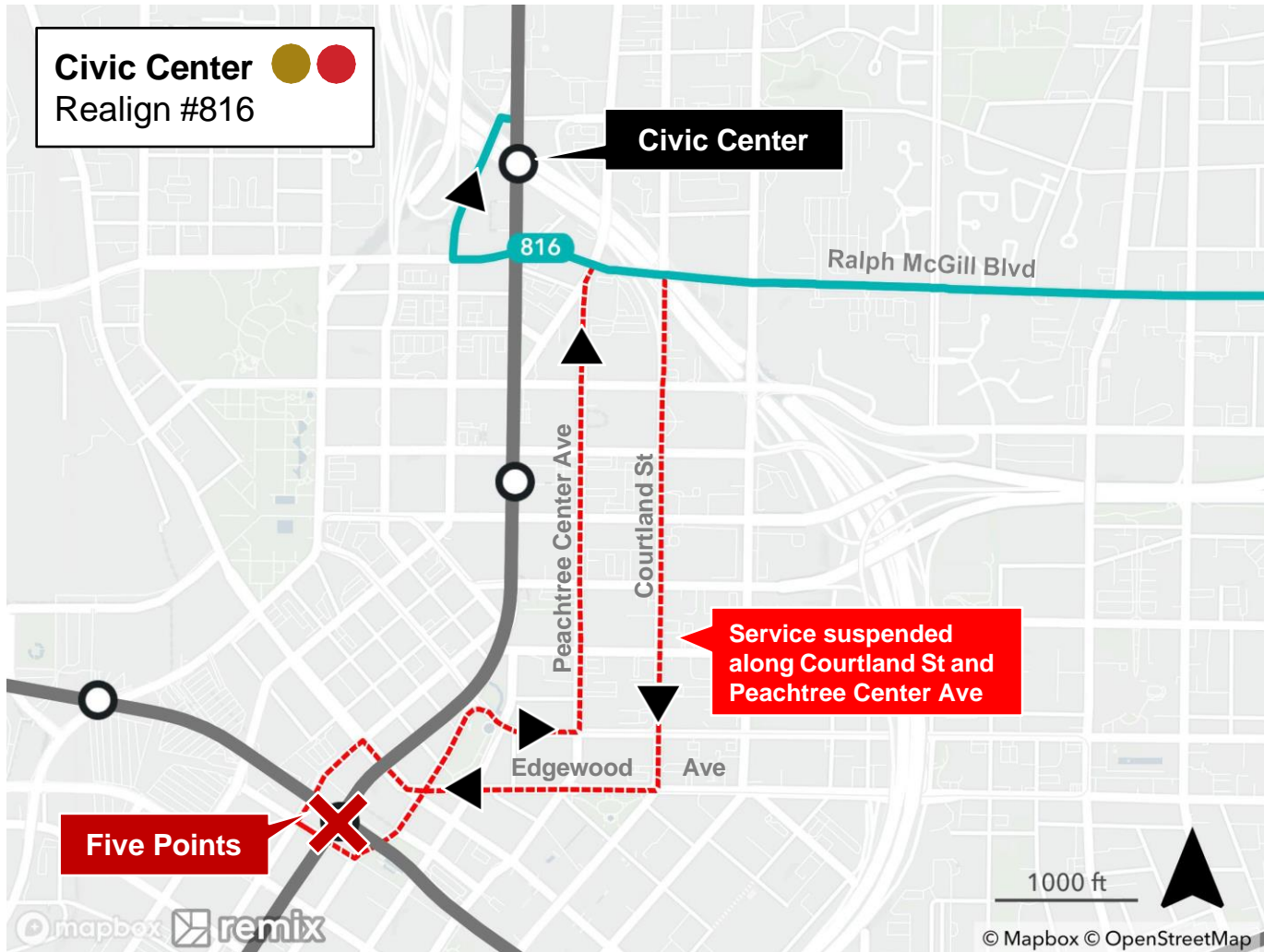

- Realign the following route to Civic Center Station
  - 816 – North Highland Ave
- Does not require additional on-street accommodations
- Service suspended along Courtland St and Peachtree Center Ave, though closed stops will remain within walking distance of other service



# Maintain Five Points Area Access by Through-Routing



- Five Points Station area is within ½ mile (10-minute walk) of other stations
- Three bus routes will continue to operate through the area during the station closure

- Route 3 – Martin Luther King Jr Dr/Auburn Ave
- Route 40 – Peachtree St/Downtown
- Route 813 – Atlanta University Center

# Five Points Transformation – ADA Rail Line Transfer Shuttle

## SERVICE PLAN

Daily Service Hours: 22

Headway: Approx. -5 Mins or Load n' Go

Runtime: 10 Minutes Roundtrip

Route Miles: 2.33

Daily Buses needed: 3

*This Alignment will connect **Georgia State Station** to **Peachtree Center Station** to accommodate North / South to East / West Transfers for non-ambulatory customers*

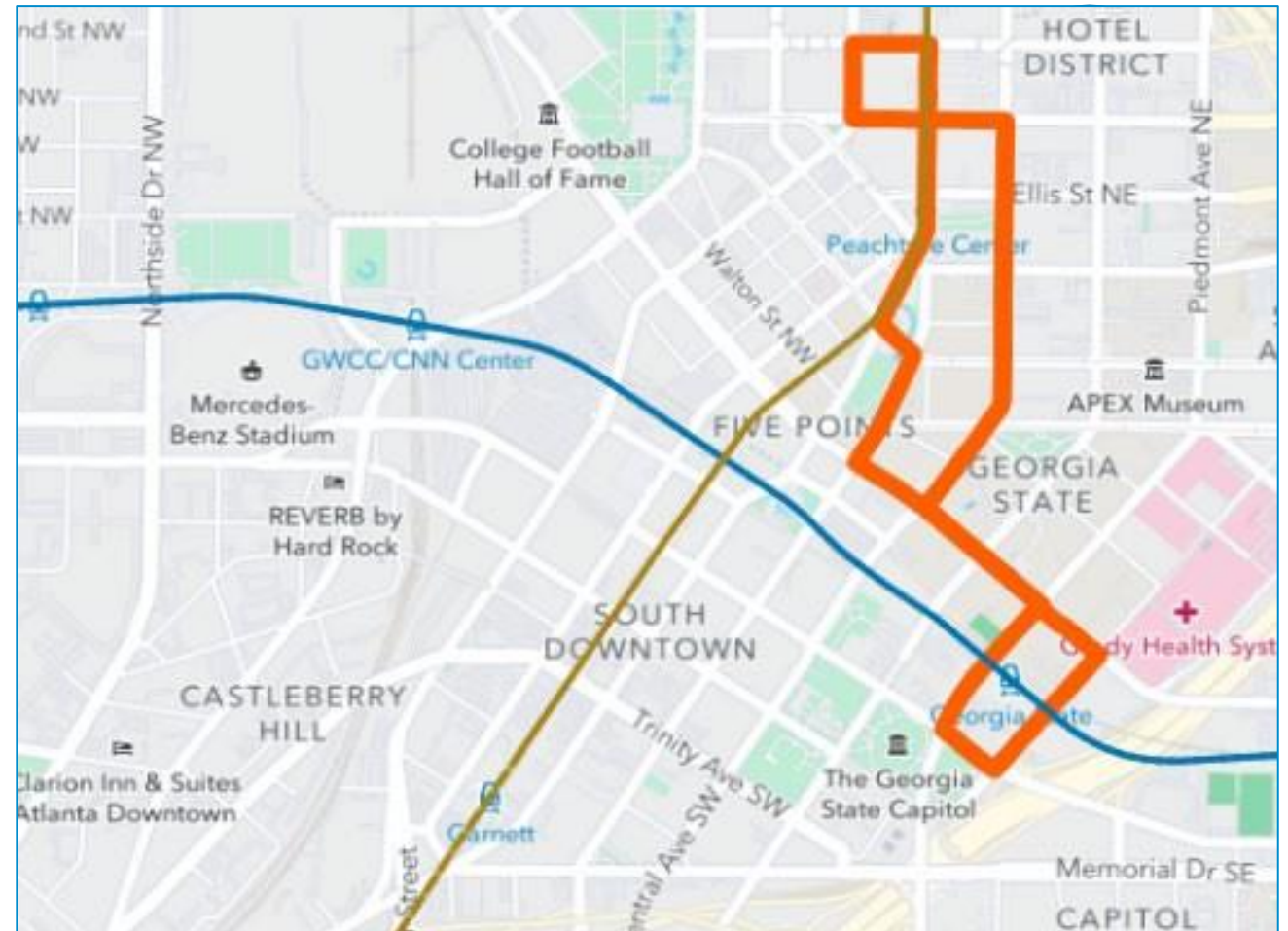

# Construction Contract – CMAR Delivery

- Skanska USA Building Inc, currently is performing preconstruction services during design of the Five Points Station.
- These services are in conjunction with SOM (designer) to provide detail plans and designs to deconstruct, demolish, and build back a new canopy structure at the Five Points Station.
- Currently, deconstruction and demolition are planned to start in June 2024. Once, the remaining design packages are complete, Skanska will be able to progress to the transformation phase of construction.





## Deconstruction Major Tasks

- Advertise forthcoming station entrance closure and construction.
- Secure construction area with fencing.
- Close entrance of station.
- Isolate concourse and plaza level power from platforms.
- Close Alabama Street (south face of station) to service as a staging area.
- Engineer removal of existing post tension concrete structure.
- Maintain existing waterproofing.



***Before deconstruction will start, all services provided by the Authority- Hope Office, Lost and Found, Reduced Fare, Ride Store, and Police - will be relocated to a temporary compound at Ashby Station West parking lot.***

## Demolition Major Tasks

- Relocate, cap and seal existing fire protection system to only service the platforms.
- Remove existing furniture.
- Remove existing escalators.
- Clear vegetation and concrete off site.

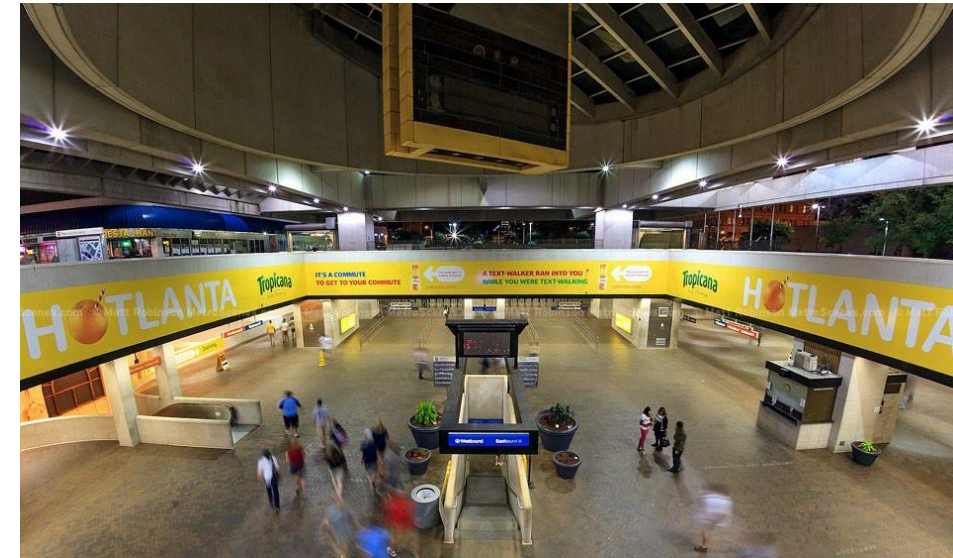

# Deconstruction / Demolition Schedule

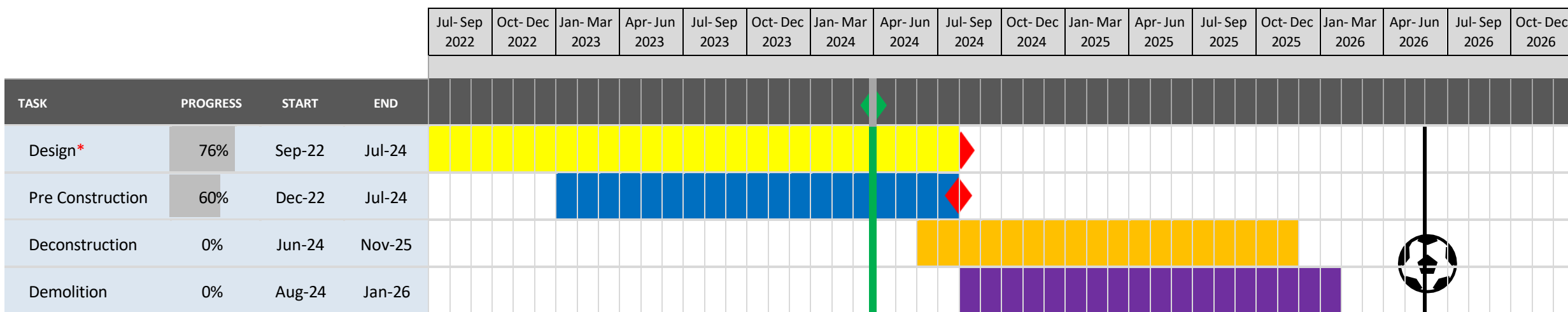

**\*Design:**

- Deconstruction and Demolition at 100%
- Build Back at 60%

**Future Construction**

- Civil
- Vertical Transportation
- Transformation (Canopy)

## Next Steps

- Received revised proposal from Skanska, under review.
- Future resolution to approve the Authorization of funding for Deconstruction of the existing canopy and Demolition of select infrastructure inside the station. ***Will return to the Board once the cost and DBE percentages have been finalized with Skanska.***

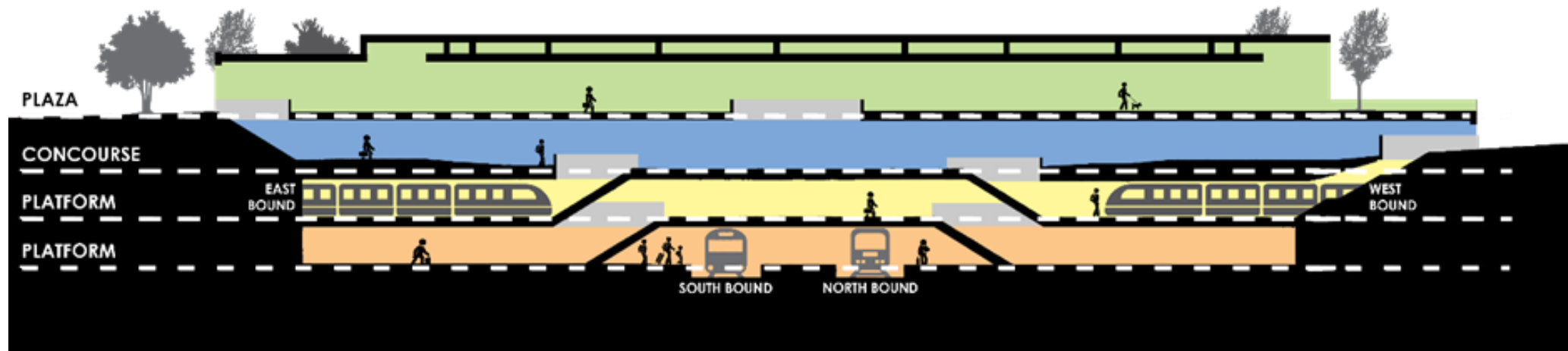



**Thank You**



# INFILL STATIONS

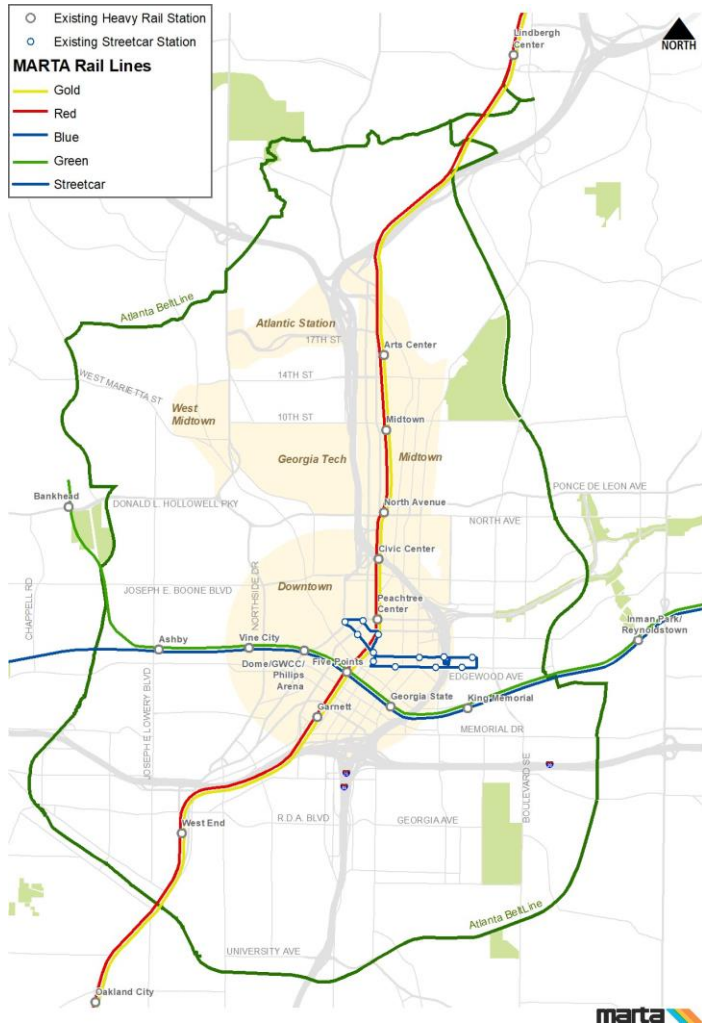

*Proposed Murphy Crossing infill station location*



# STREETCAR EAST EXTENSION

Work on this project is focused on two areas of study:

- The feasibility and cost for replacing wired streetcars with smaller, electric, off-catenary wire trains.
- How to improve the efficiency and experience of the existing streetcar.





# Five Points Station Transformation Project Briefing

---

Planning & Capital Programs  
Committee

March 28, 2024

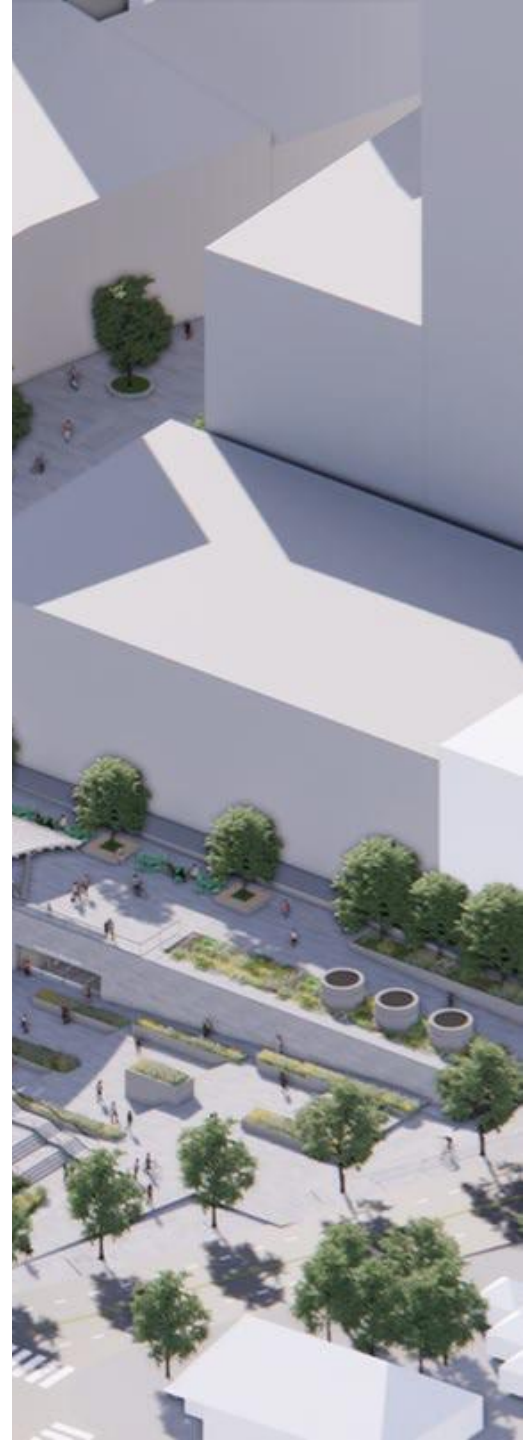

## Briefing Contents

Project Status – Path to Construction Start  
 Construction Impacts to Customers  
 Next Steps

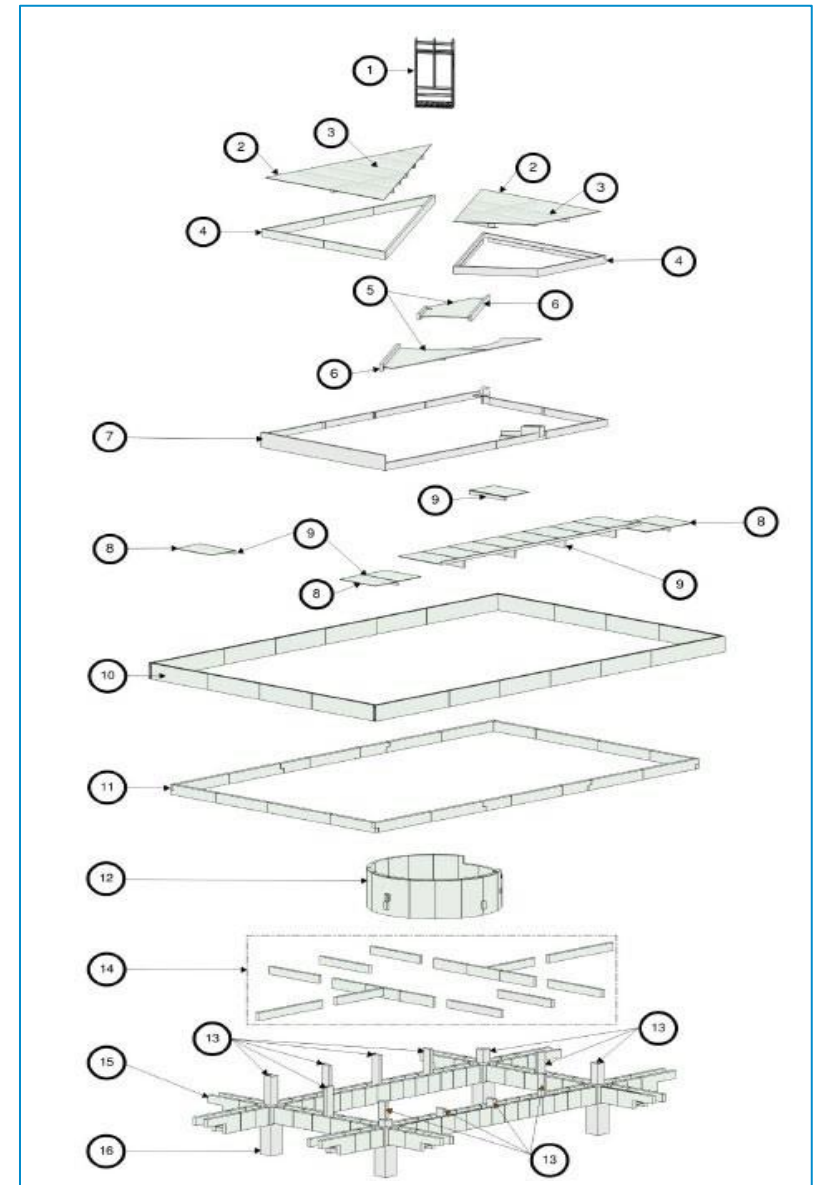



# Project Status – Path to Construction Start

## Completed Activities

- ✓ Memorandum of Agreement (MOA) for Mitigation – 1/9/24
- ✓ Environmental Assessment (EA) Public Comments & Responses – 12/1/23 – 1/5/24
- ✓ Finding of No Significant Impact (FONSI) – 3/25/24
- ✓ Section 4(f) Documentation Completed – 3/25/24
- ✓ Historic American Buildings Survey (HABS) Photography by National Park Service (NPS) – 1/10/24

## In-Progress Activities

- ❑ RAISE Paper Grant Agreement (PGA) to be Signed
- ❑ Site Plans for Accommodations Needed for Temporary Stops
- ❑ Finalize Plans for ADA Access Shuttle
- ❑ Deconstruction & Demolition CGMP Negotiations Complete
- ❑ Board Authorization for Deconstruction & Demolition Contracts

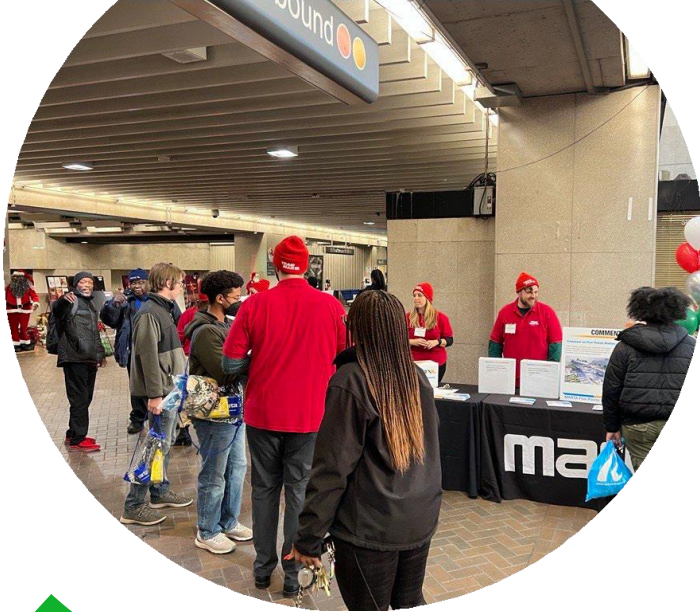







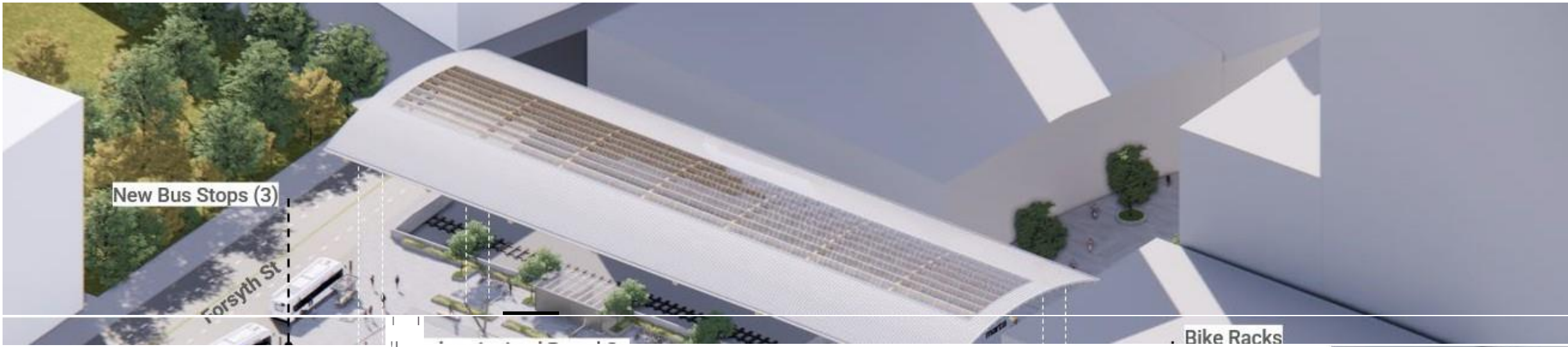

New Bus Stops (3)

Forsyth St

Bike Racks



Bike Racks

Bike Racks

Shaded Plaza  
Shaded Plaza  
New Street Trees

Station Soccer

Alabama St

Shaded Plaza

Community Garden

New Bus Stops (5)

Native Plantings

Plaza on Peachtree

Peachtree St



## **Construction Phase Planning**

---

- Minimize disruption to travel patterns by providing continued access to Downtown and nearby stations
- No pedestrian or bus access to Five Points Station
- Rail transfers are possible within the station
- When project is complete, routes should be restored to serve Five Points (as planned through the Bus Network Redesign project)





## Detour Strategies

---



Maintain direct downtown access where possible by continuing through-routing where it already exists



Detour bus routes that terminate and layover at Five Points Station to other nearby stations



Increase capacity at nearby stations by making temporary/tactical transit accommodations (coordinated with City of Atlanta)



Adjust key schedules in April 2024 mark-up to prepare for detours

# Rider Impacts

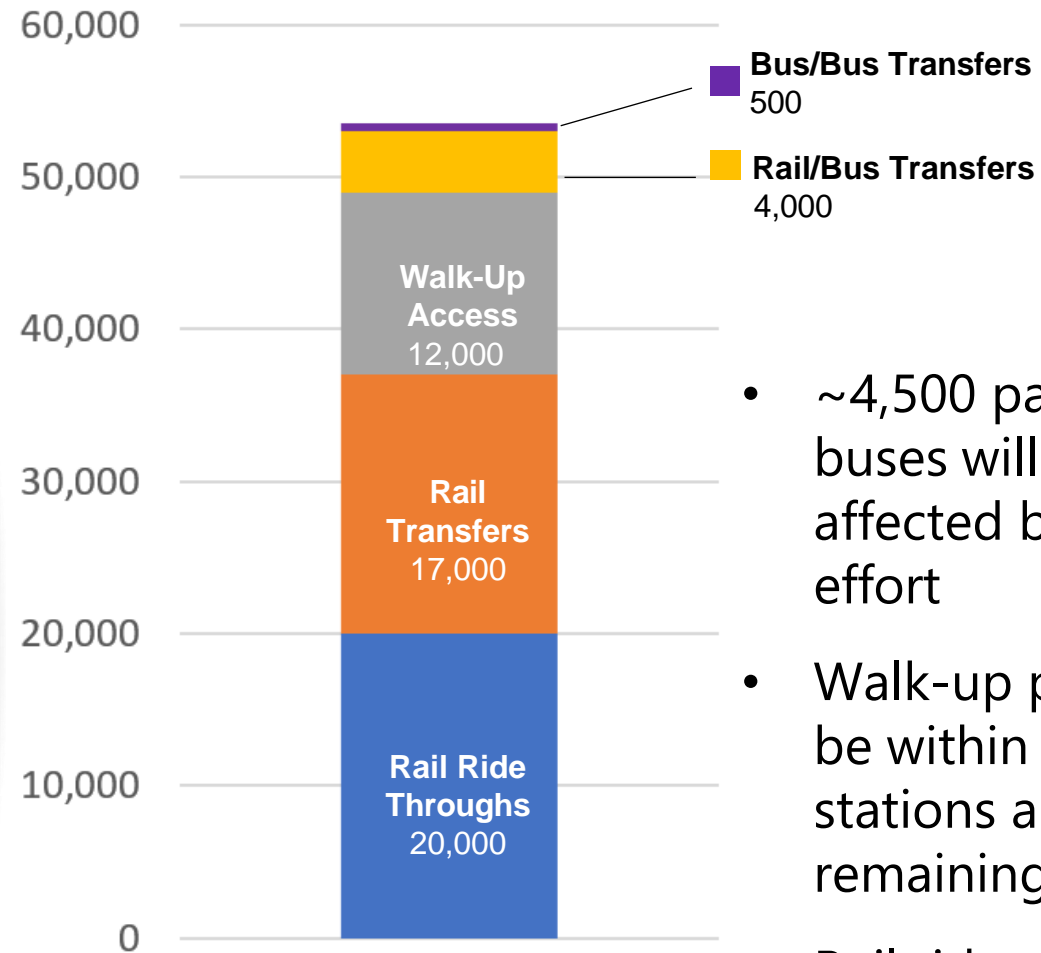

*Five Points Weekday Ridership by Means of Access*

- ~4,500 passengers using buses will be significantly affected by the detour effort
- Walk-up passengers will be within 1/2 mile of other stations and will have remaining bus options
- Rail ride-through passengers and most of those making rail line transfers will not be affected

## Operational Changes & Customer Impacts During Construction

- No pedestrian access at street levels; contractor and emergency access/egress only.
- Concourse Level (faregates) will be closed
  - No patron restrooms; employee restroom near Marble Room on outer East Platform
  - No elevator access from N/S to E/W Platform levels; must ride to adjacent station(s) and return on opposite direction to access other platform
- Transfers for rail service between platforms will not be affected.
- Closure to plaza/concourse is planned for 18 months, duration will be refined as design progresses.
- Accommodations will be made to reopen the plaza/concourse access during the World Cup.
- Construction will continue through 2028.





# Ashby Station Relocation

MARTA Police Central Precinct (west line) – coverage maintained in station ●

Lost and Found ●  
Reduced Fare ●

Ride Store ●  
MARTA HOPE ●

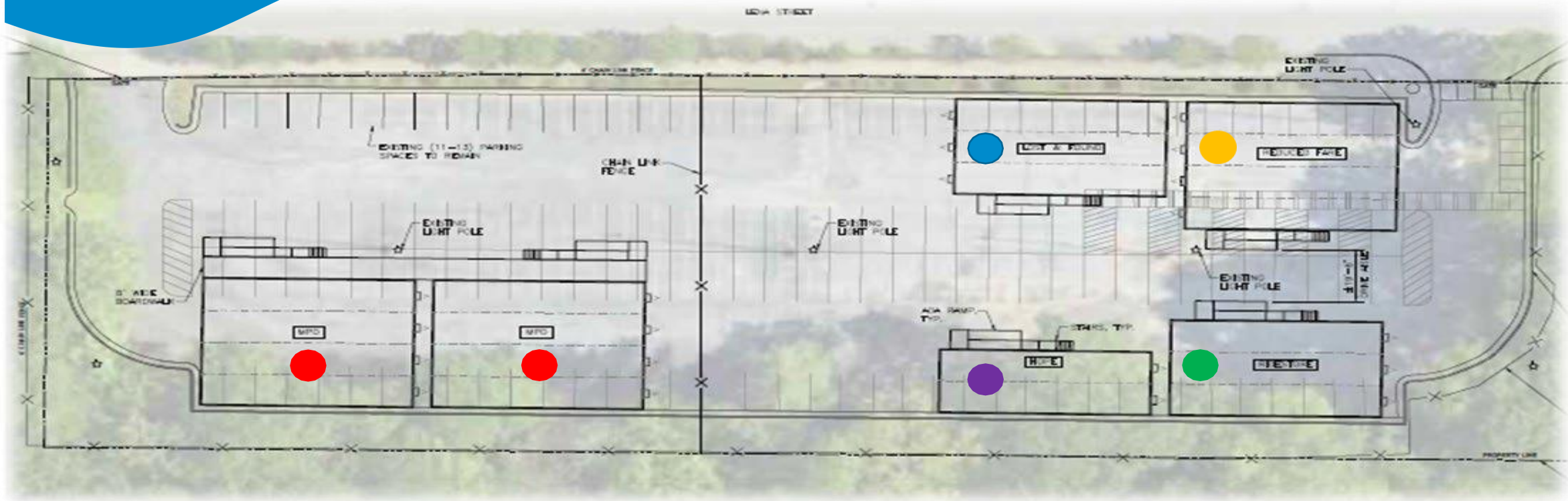

**Closing During  
Construction**

FIVE POINTS FARM

A MARTA MAKEOVER COMMUNITY GARDEN

marta<sup>®</sup>  
market



Station  
Soccer<sup>®</sup>  
*Atlanta*

Connecting communities through transit, soccer, and leadership training.

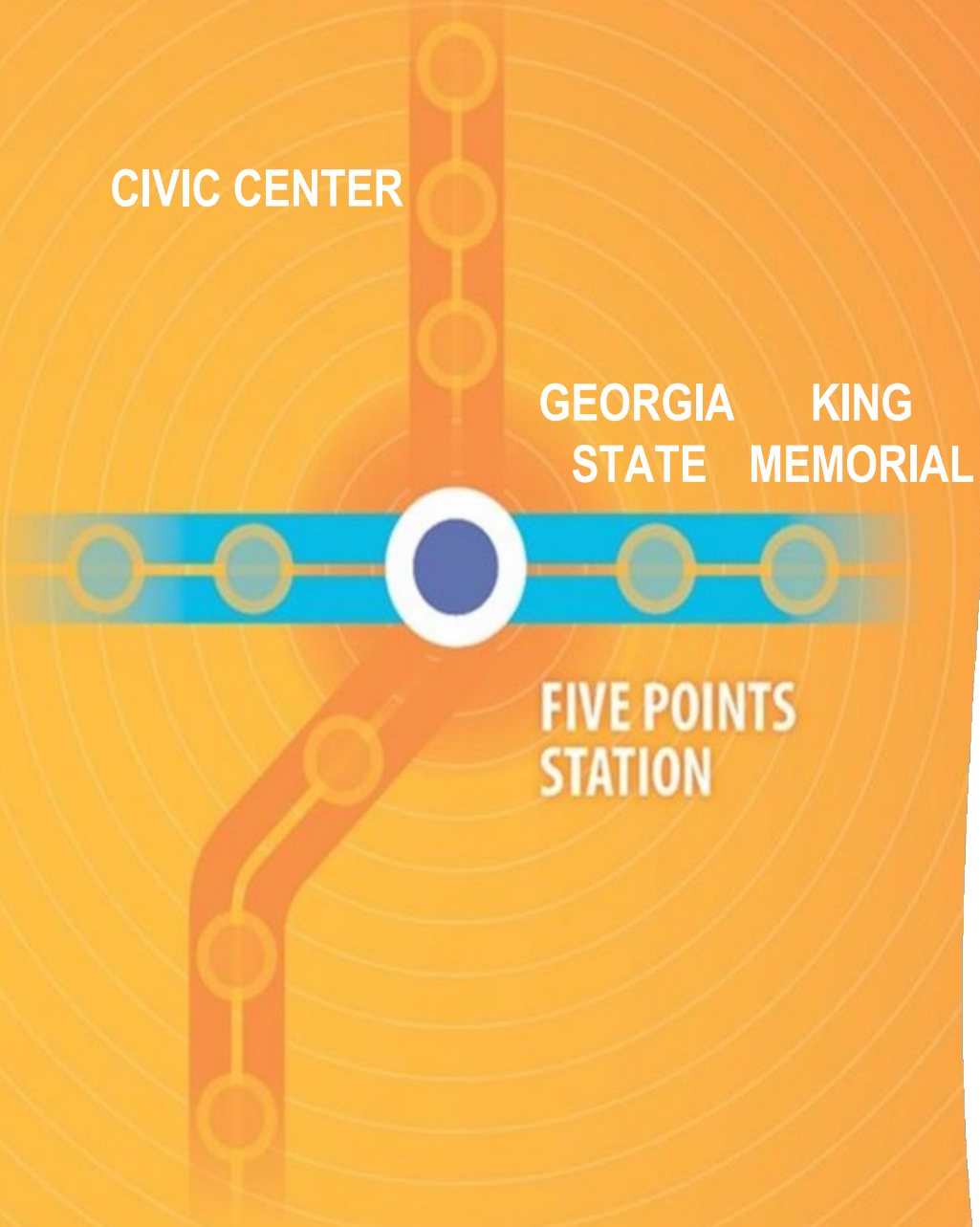

| Rail Station         | Bus Routes Detoured  |
|----------------------|--|
| <b>Georgia State</b> | 21 – Memorial Dr<br>42 – Pryor Rd<br>49 – McDonough Blvd<br>55 – Jonesboro Rd<br>186 – Rainbow Dr/South DeKalb |
| <b>King Memorial</b> | 26 – Marietta St/Perry Blvd<br>899 – Old Fourth Ward   |
| <b>Civic Center</b>  | 816 – North Highland Ave   |

|   |   |
|---|---|
| <b>Through-Routed to Maintain Service in Five Points Area</b> | Route 3 – Martin Luther King Jr Dr/Auburn Ave<br>Route 40 – Peachtree St/ Downtown<br>Route 813 – Atlanta University Center |
|---|---|



# Detour Routes to Georgia State

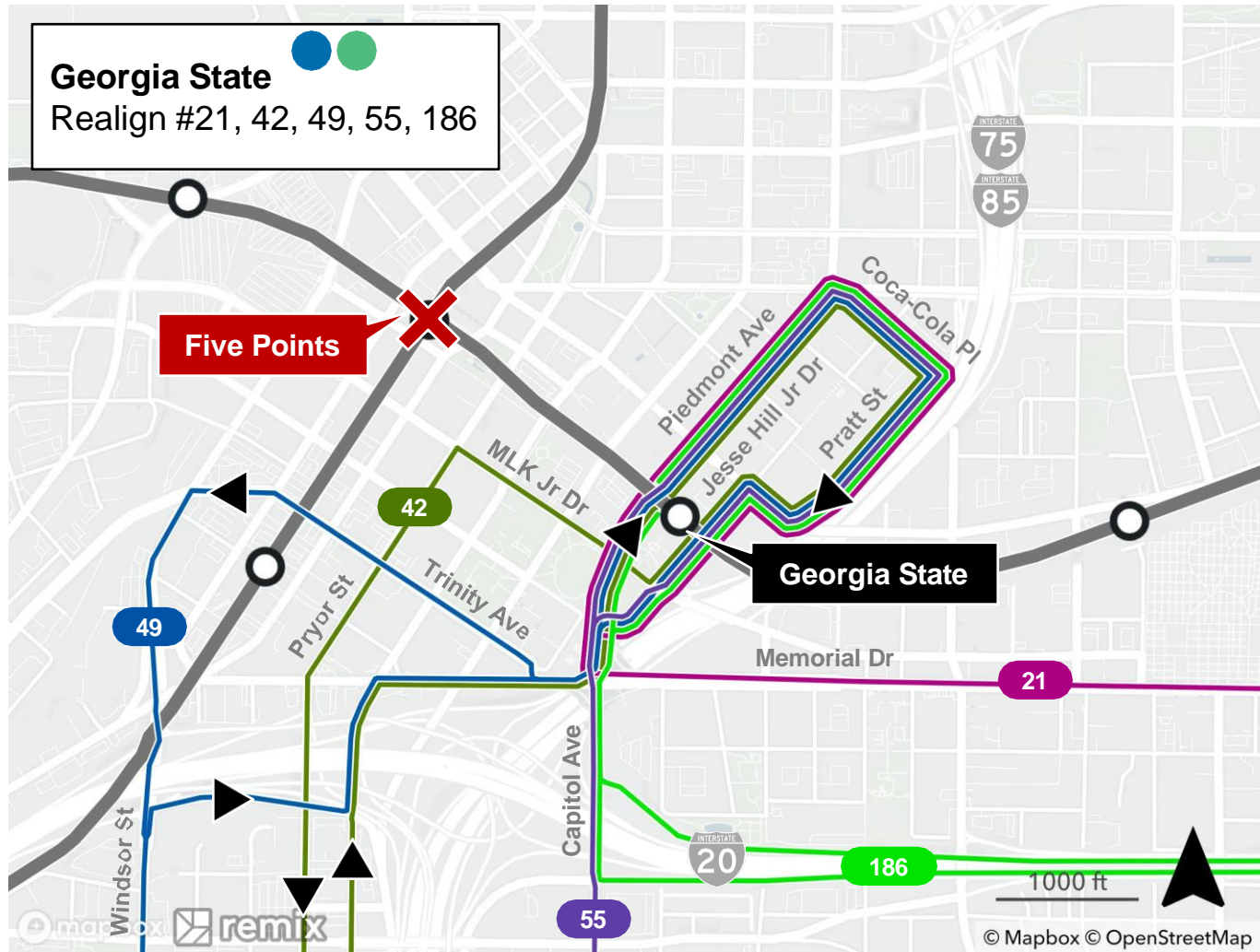

- Realign the following routes to Georgia State Station
  - 21 – Memorial Dr
  - 42 – Pryor Rd
  - 49 – McDonough Blvd
  - 55 – Jonesboro Rd
  - 186 – Rainbow Dr/South DeKalb
- Operational and Customer Experience challenges at the station will be addressed

# Detour Routes to Georgia State

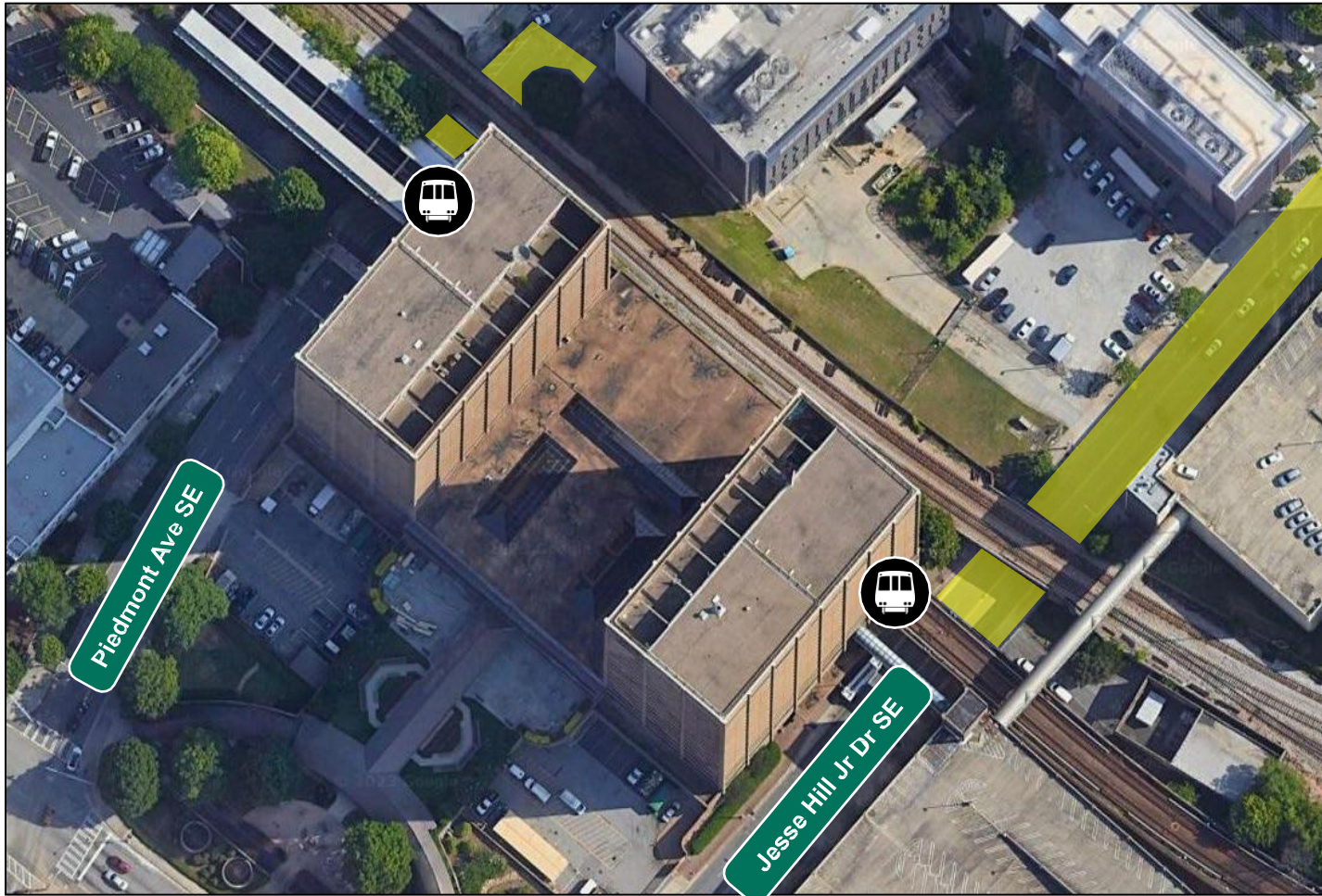

- **Temporary bus stop zones** to be added on Piedmont Ave and Jesse Hill Jr Dr
- Additional layover-only space will be added on Jesse Hill Jr Dr
- On Piedmont Ave, we will be converting no parking areas to **dedicated parking for MARTA fleet vehicles**



Rail station entrance



Detoured bus operations to be relocated to these areas



# Detour Routes to Georgia State On-Street Accommodations

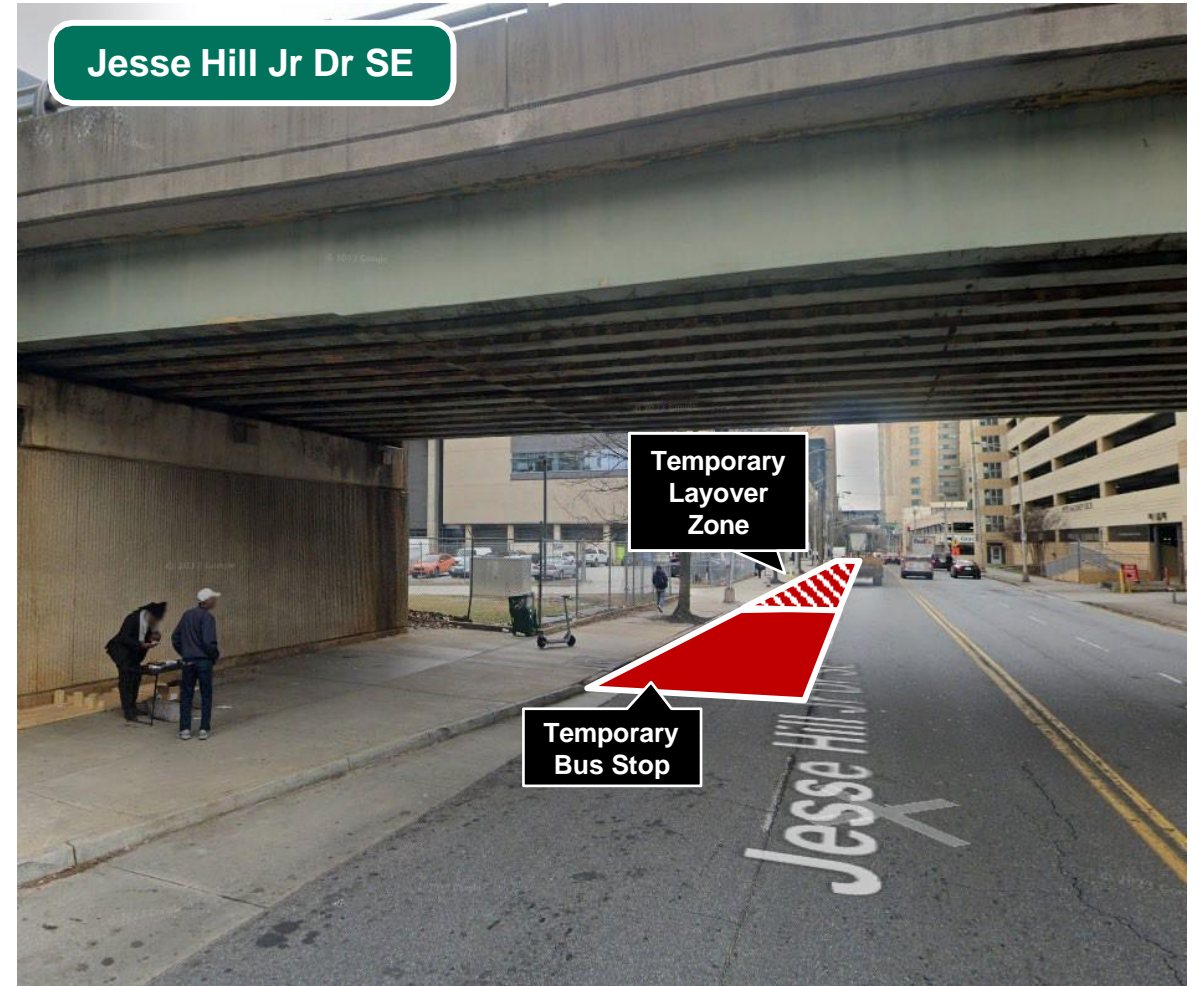
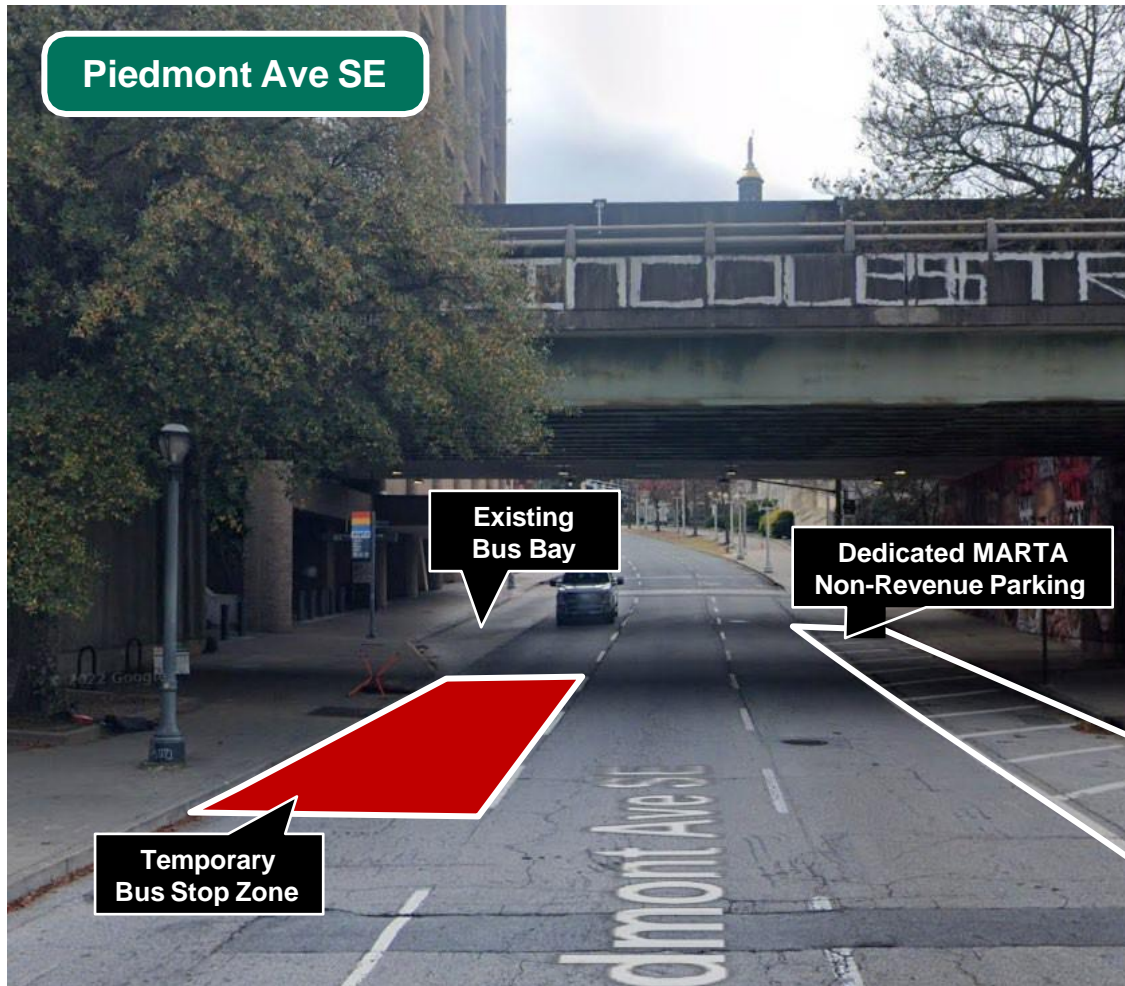



# Detour Routes to Georgia State On-Street Accommodations

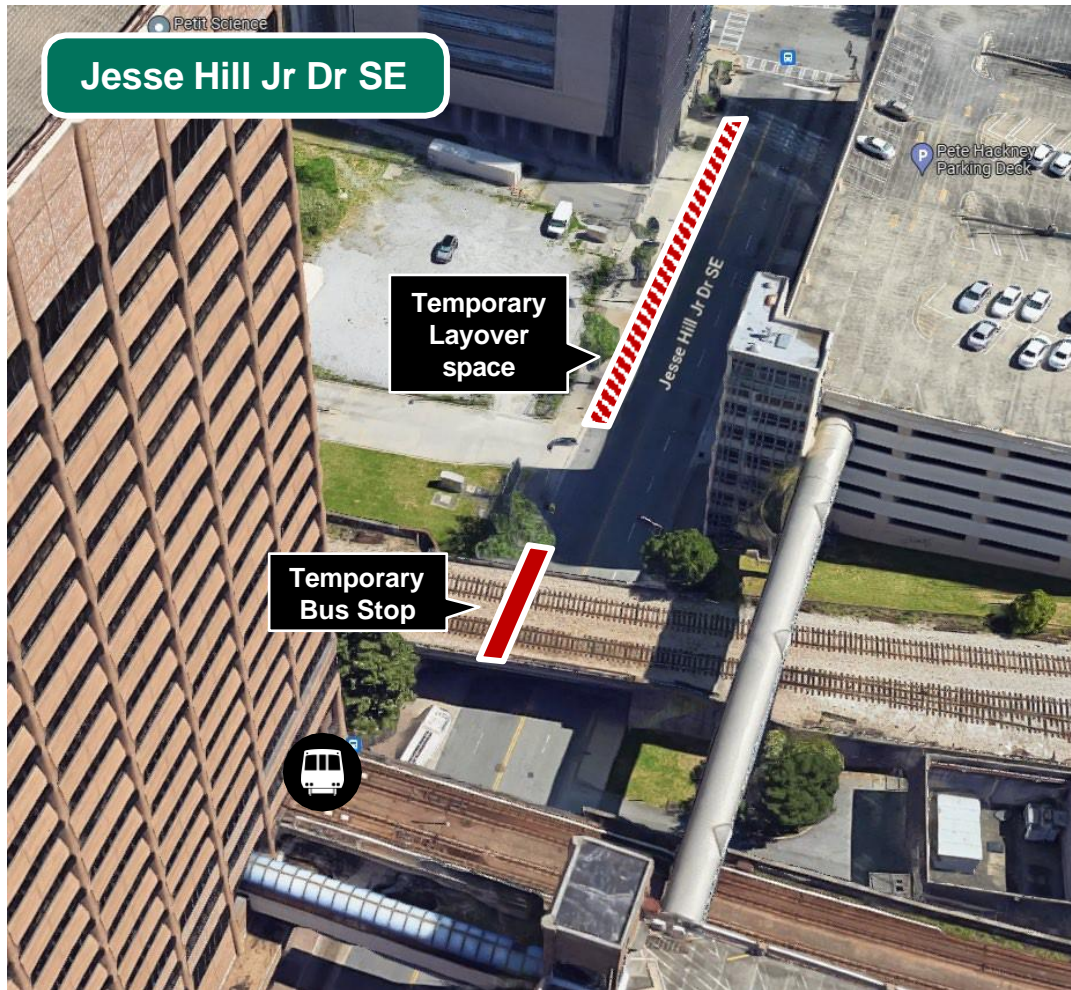

- On Jesse Hill Jr Dr, a **temporary bus stop** to be added under the freight railroad bridge
- Additional **layover-only space** to be established along Jesse Hill Jr Dr, clear of the GSU Petit Science Center service driveway



Rail station entrance

# Detour Routes to King Memorial

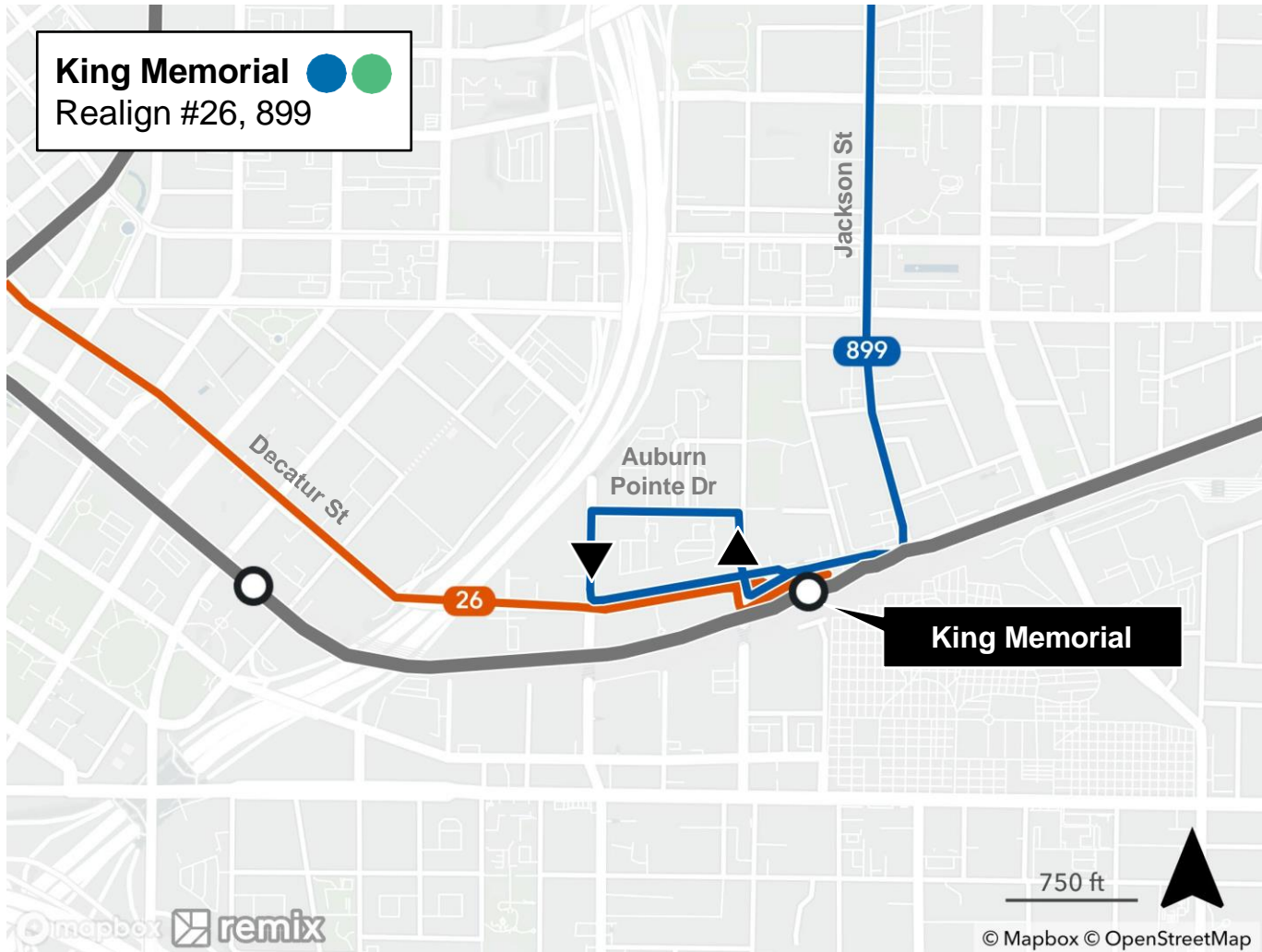

- Realign the following routes to King Memorial Station
  - 26 – Marietta St/Perry Blvd
  - 899 – Old Fourth Ward
- Does not require additional on-street accommodations

# Detour Service to Civic Center

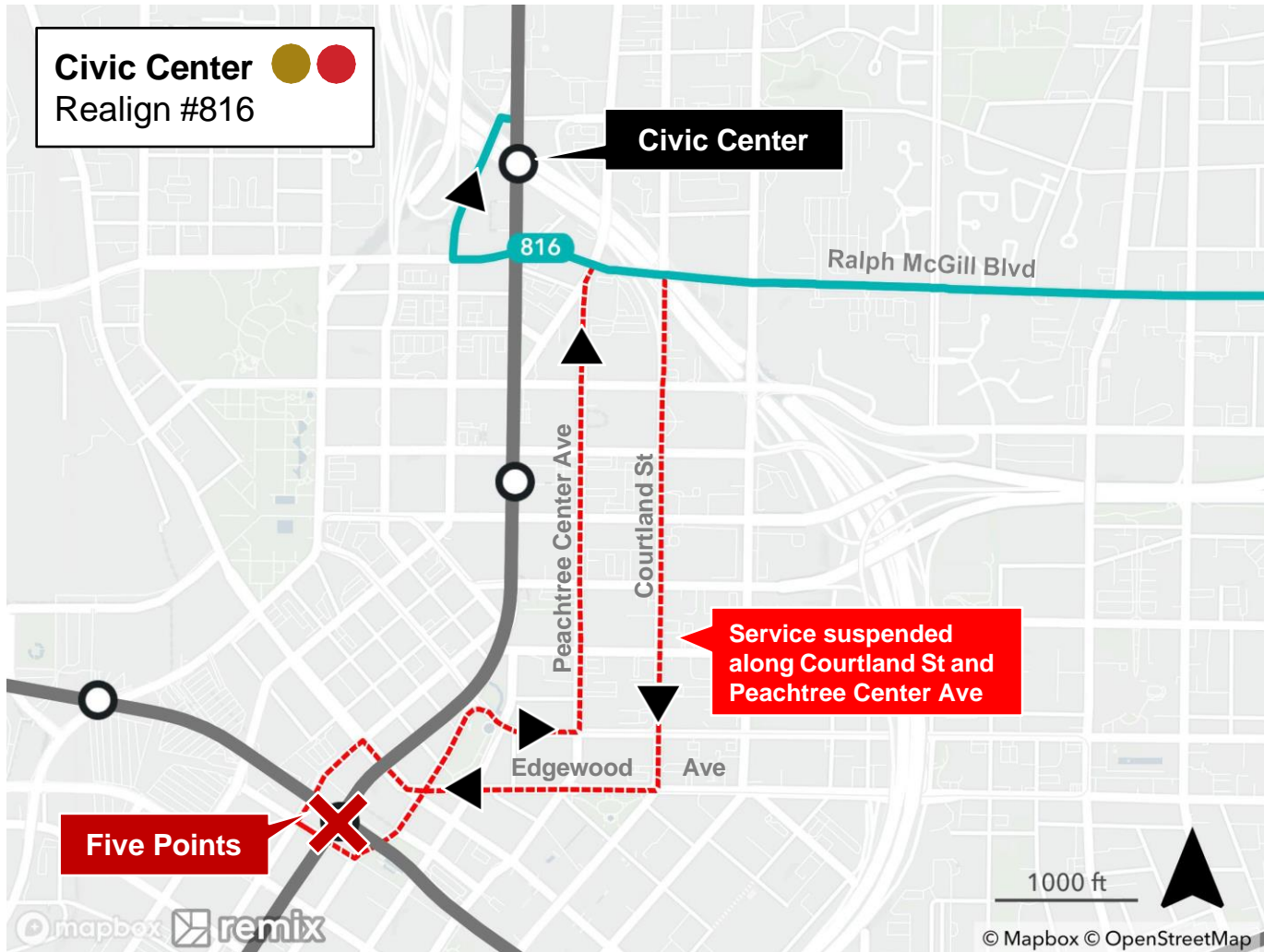

- Realign the following route to Civic Center Station
  - 816 – North Highland Ave
- Does not require additional on-street accommodations
- Service suspended along Courtland St and Peachtree Center Ave, though closed stops will remain within walking distance of other service



# Maintain Five Points Area Access by Through-Routing

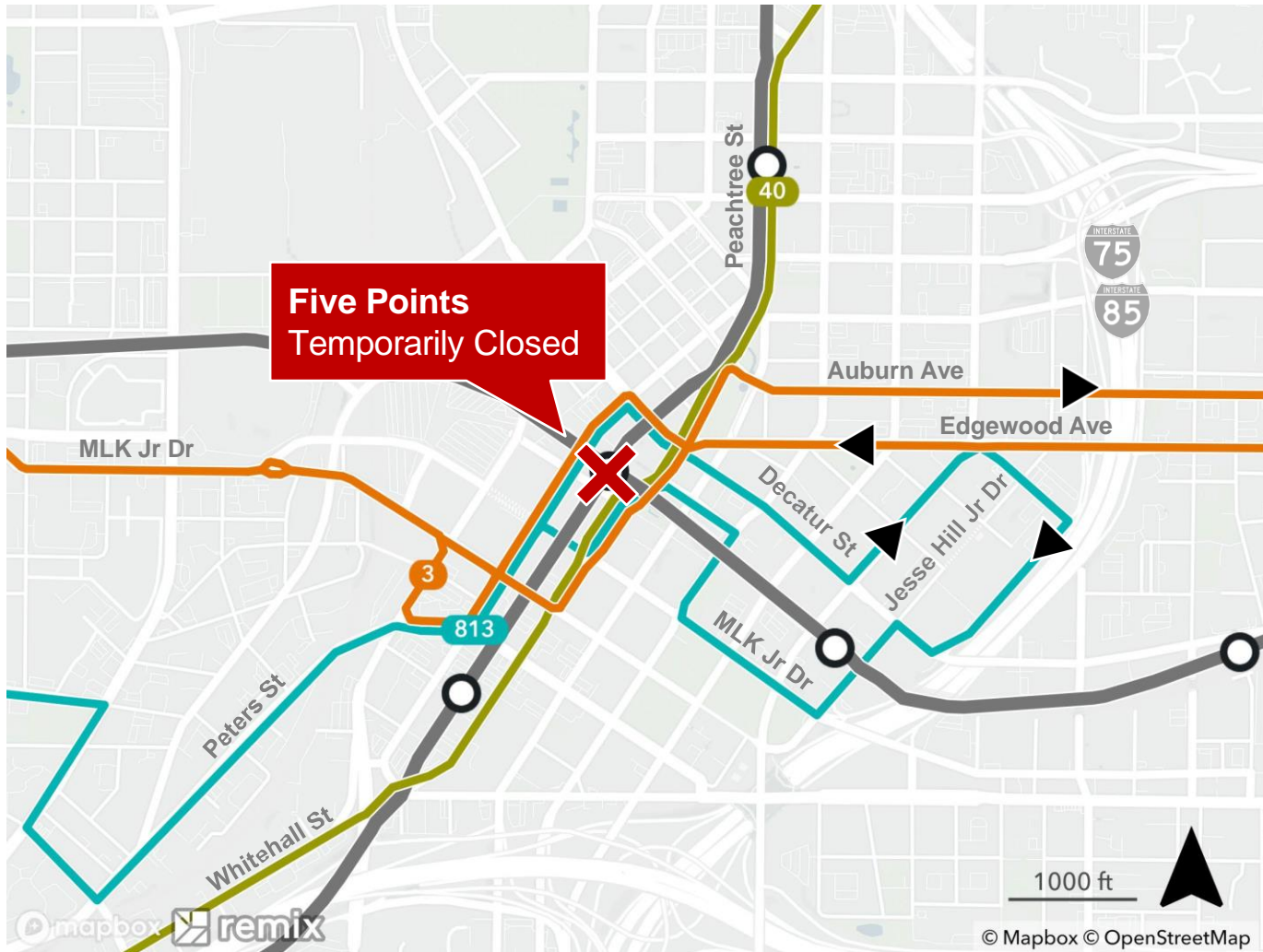

- Five Points Station area is within ½ mile (10-minute walk) of other stations
- Three bus routes will continue to operate through the area during the station closure

- Route 3 – Martin Luther King Jr Dr/Auburn Ave
- Route 40 – Peachtree St/Downtown
- Route 813 – Atlanta University Center

# Five Points Transformation – ADA Rail Line Transfer Shuttle

## SERVICE PLAN

Daily Service Hours: 22

Headway: Approx. -5 Mins or Load n' Go

Runtime: 10 Minutes Roundtrip

Route Miles: 2.33

Daily Buses needed: 3

*This Alignment will connect **Georgia State Station** to **Peachtree Center Station** to accommodate North / South to East / West Transfers for non-ambulatory customers*

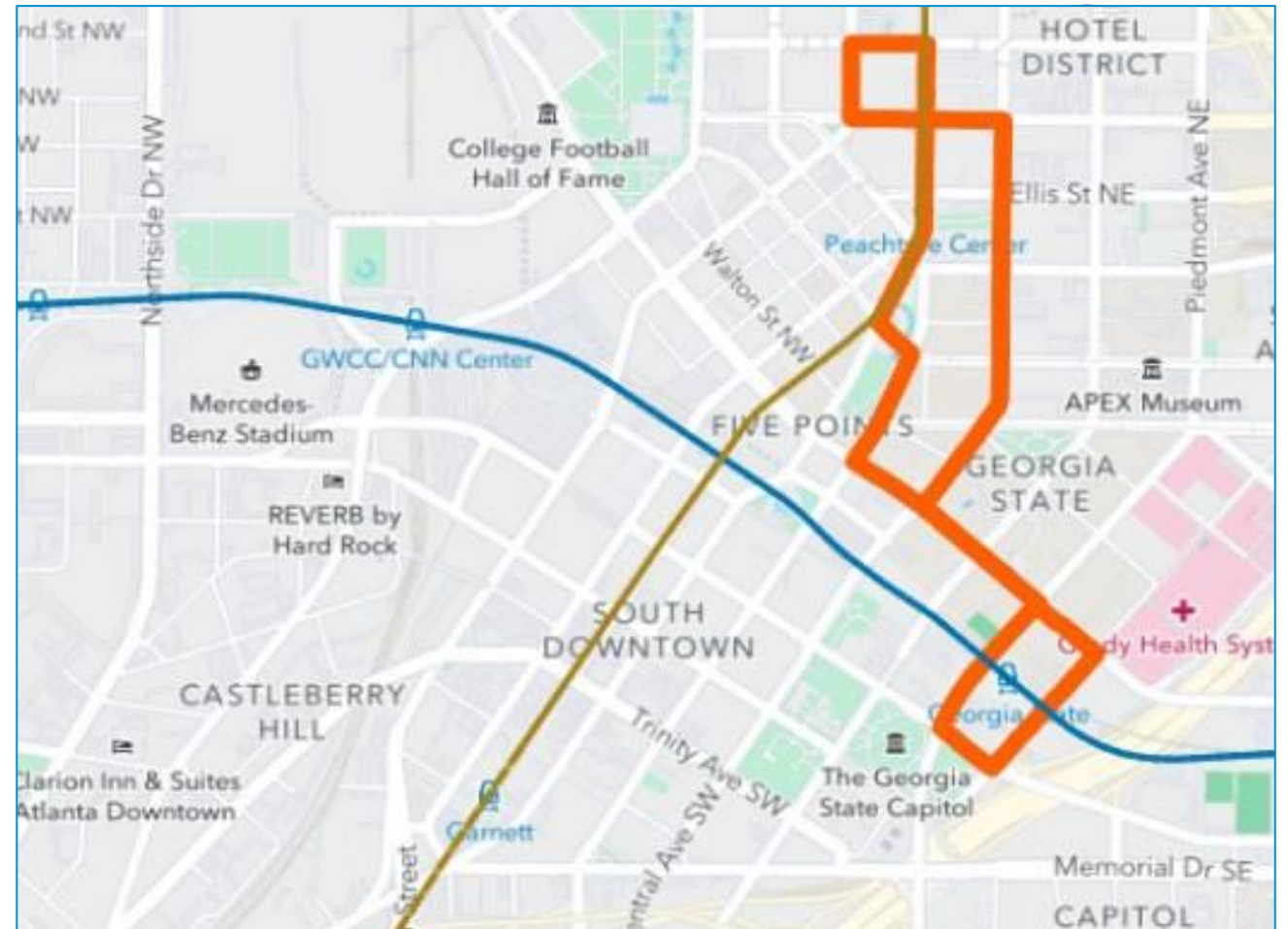

# Construction Contract – CMAR Delivery

- Skanska USA Building Inc, currently is performing preconstruction services during design of the Five Points Station.
- These services are in conjunction with SOM (designer) to provide detail plans and designs to deconstruct, demolish, and build back a new canopy structure at the Five Points Station.
- Currently, deconstruction and demolition are planned to start in June 2024. Once, the remaining design packages are complete, Skanska will be able to progress to the transformation phase of construction.





## Deconstruction Major Tasks

- Advertise forthcoming station entrance closure and construction.
- Secure construction area with fencing.
- Close entrance of station.
- Isolate concourse and plaza level power from platforms.
- Close Alabama Street (south face of station) to service as a staging area.
- Engineer removal of existing post tension concrete structure.
- Maintain existing waterproofing.



***Before deconstruction will start, all services provided by the Authority- Hope Office, Lost and Found, Reduced Fare, Ride Store, and Police - will be relocated to a temporary compound at Ashby Station West parking lot.***

## Demolition Major Tasks

- Relocate, cap and seal existing fire protection system to only service the platforms.
- Remove existing furniture.
- Remove existing escalators.
- Clear vegetation and concrete off site.

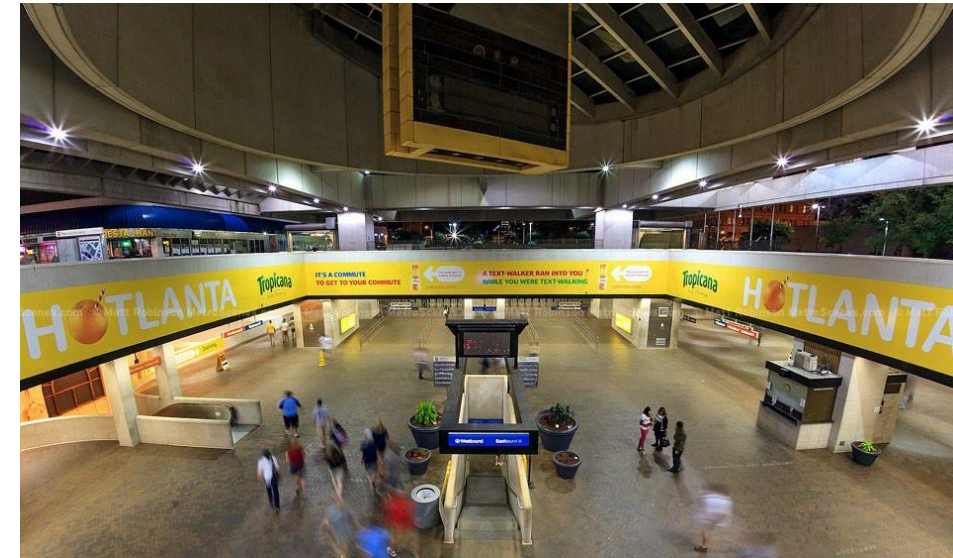

# Deconstruction / Demolition Schedule

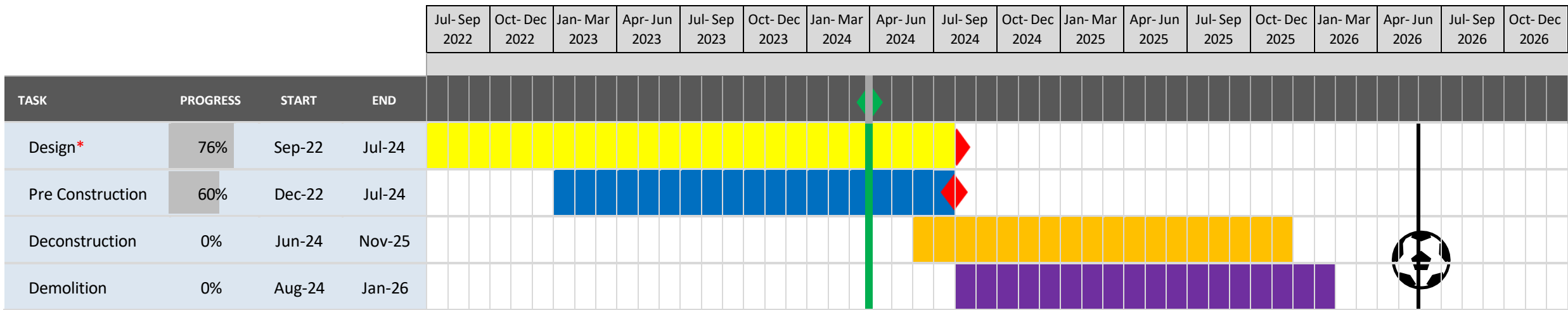

**\*Design:**

- Deconstruction and Demolition at 100%
- Build Back at 60%

**Future Construction**

- Civil
- Vertical Transportation
- Transformation (Canopy)



## Next Steps

- Received revised proposal from Skanska, under review.
- Future resolution to approve the Authorization of funding for Deconstruction of the existing canopy and Demolition of select infrastructure inside the station. ***Will return to the Board once the cost and DBE percentages have been finalized with Skanska.***

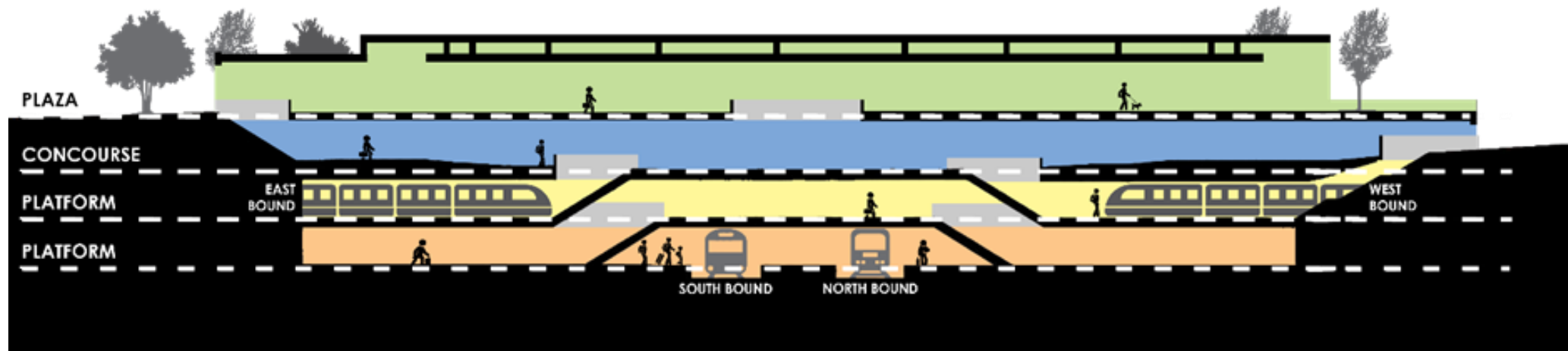



**Thank You**

# INFILL STATIONS

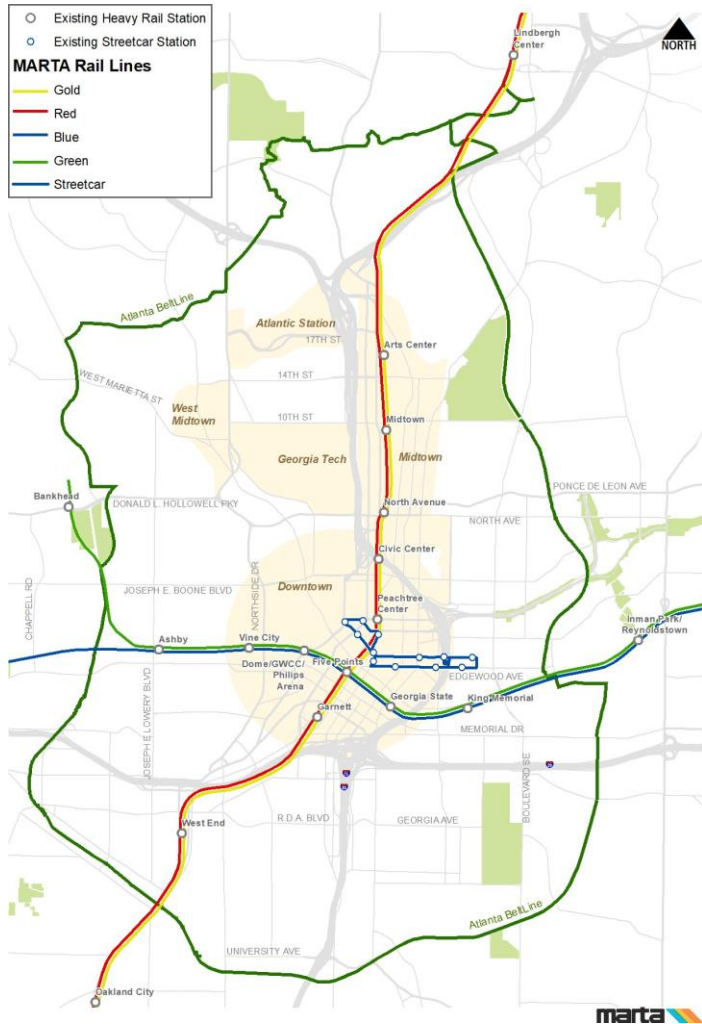

Proposed Murphy Crossing infill station location



# STREETCAR EAST EXTENSION

Work on this project is focused on two areas of study:

- The feasibility and cost for replacing wired streetcars with smaller, electric, off-catenary wire trains.
- How to improve the efficiency and experience of the existing streetcar.





# Five Points Station Transformation Project Briefing

---

Planning & Capital Programs  
Committee

March 28, 2024

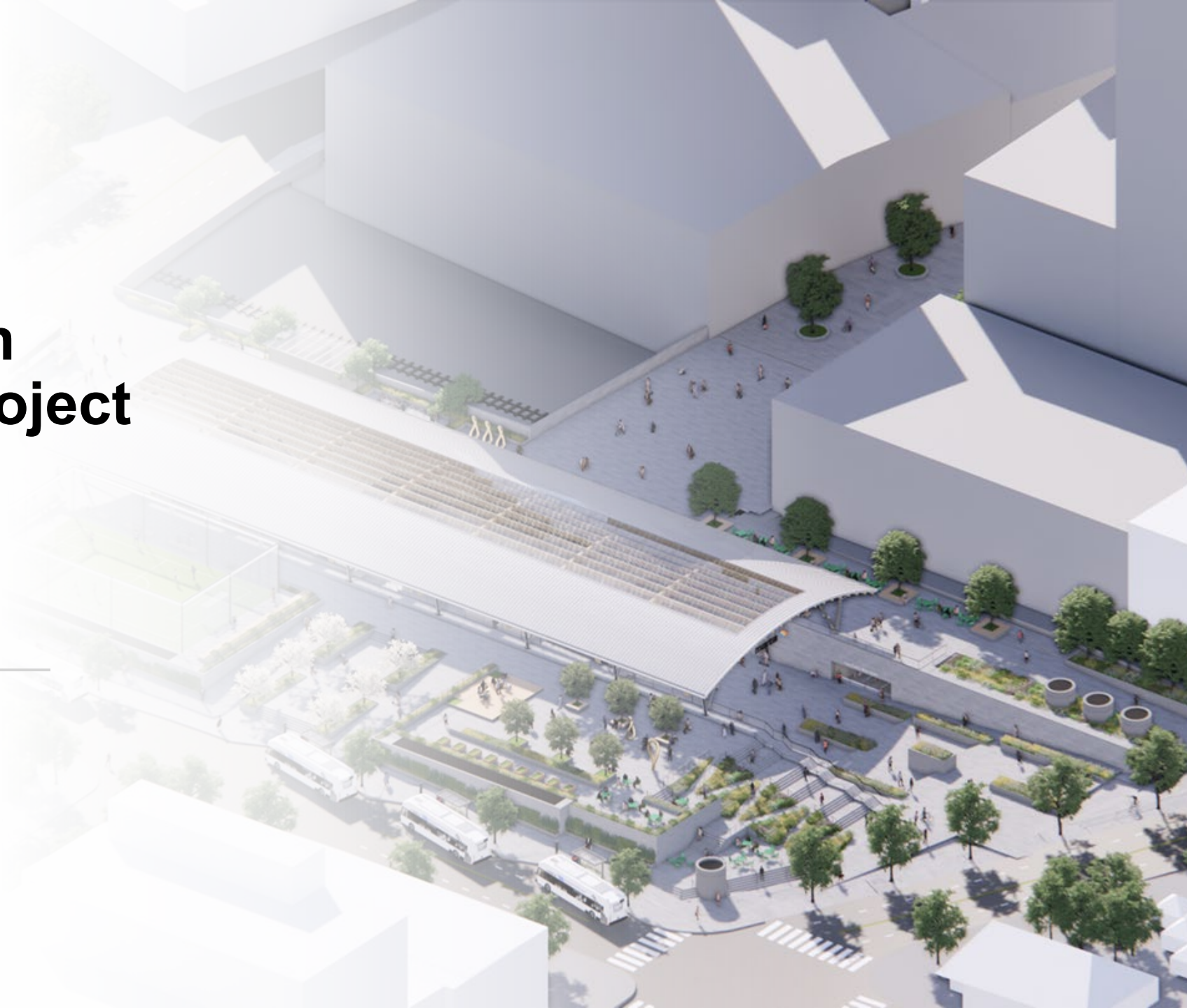



## Briefing Contents

Project Status – Path to Construction Start  
 Construction Impacts to Customers  
 Next Steps

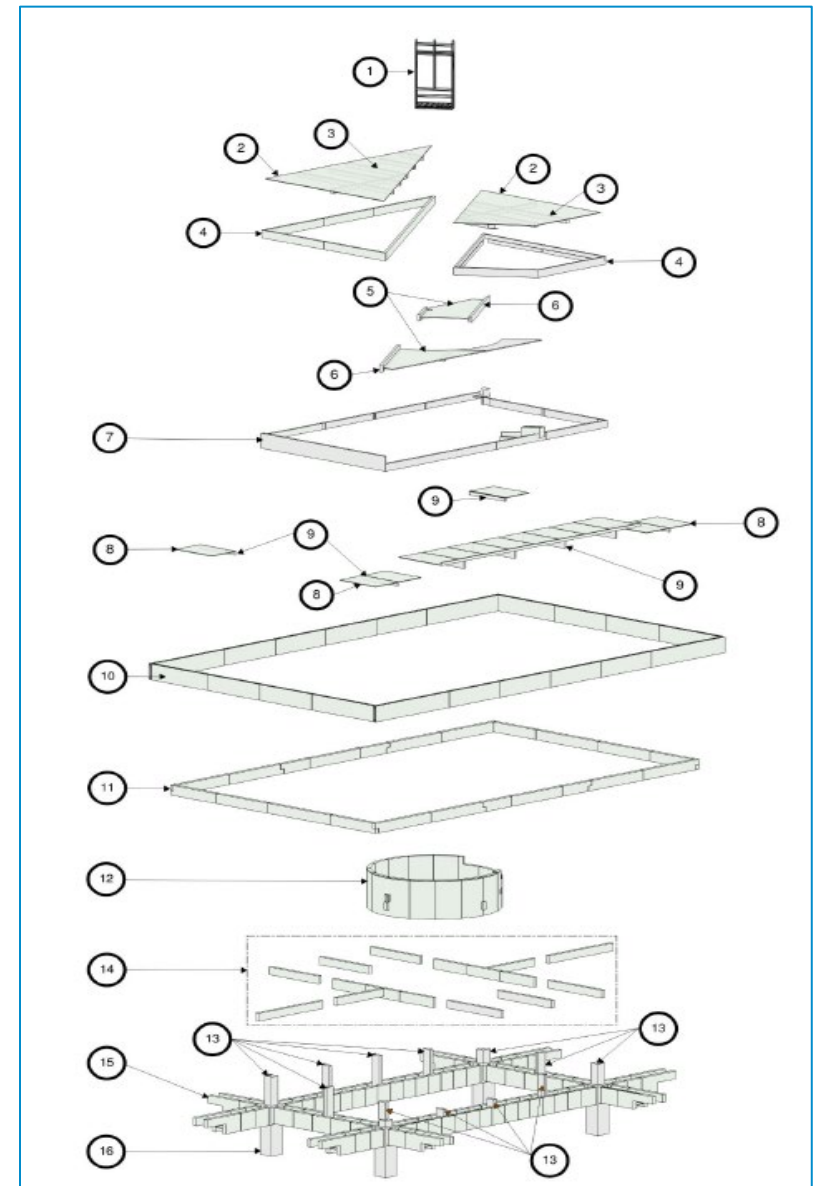



# Project Status – Path to Construction Start

## Completed Activities

- ✓ Memorandum of Agreement (MOA) for Mitigation – 1/9/24
- ✓ Environmental Assessment (EA) Public Comments & Responses – 12/1/23 – 1/5/24
- ✓ Finding of No Significant Impact (FONSI) – 3/25/24
- ✓ Section 4(f) Documentation Completed – 3/25/24
- ✓ Historic American Buildings Survey (HABS) Photography by National Park Service (NPS) – 1/10/24

## In-Progress Activities

- ❑ RAISE Paper Grant Agreement (PGA) to be Signed
- ❑ Site Plans for Accommodations Needed for Temporary Stops
- ❑ Finalize Plans for ADA Access Shuttle
- ❑ Deconstruction & Demolition CGMP Negotiations Complete
- ❑ Board Authorization for Deconstruction & Demolition Contracts











New Bus Stops (3)

Forsyth St

Pedestrianized Broad St Connection

Bike Racks

Shaded Plaza

New Street Trees

Station Soccer

Alabama St

Shaded Plaza

Community Garden

New Bus Stops (5)

Peachtree St

Plaza on Peachtree

Native Plantings





## **Construction Phase Planning**

---

- Minimize disruption to travel patterns by providing continued access to Downtown and nearby stations
- No pedestrian or bus access to Five Points Station
- Rail transfers are possible within the station
- When project is complete, routes should be restored to serve Five Points (as planned through the Bus Network Redesign project)



## Detour Strategies

---



Maintain direct downtown access where possible by continuing through-routing where it already exists



Detour bus routes that terminate and layover at Five Points Station to other nearby stations



Increase capacity at nearby stations by making temporary/tactical transit accommodations (coordinated with City of Atlanta)



Adjust key schedules in April 2024 mark-up to prepare for detours

# Rider Impacts

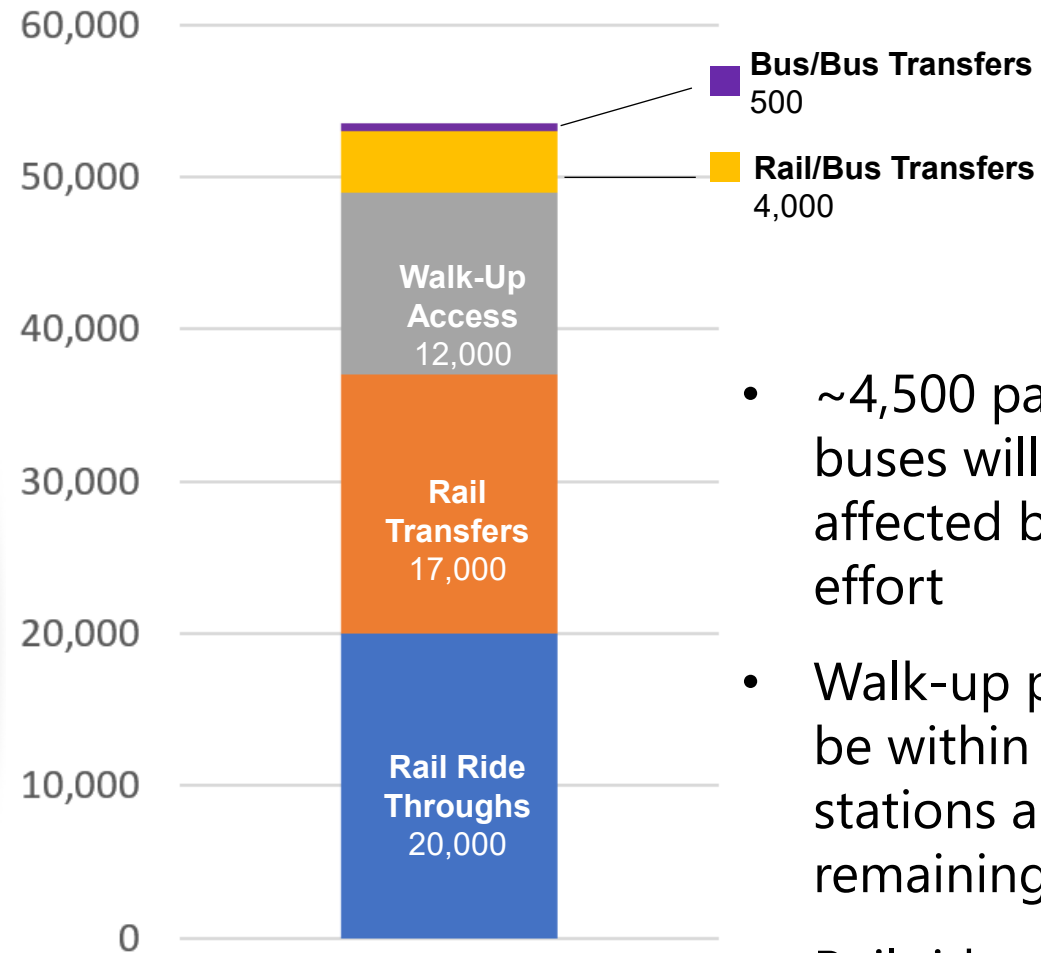

*Five Points Weekday Ridership by Means of Access*

- ~4,500 passengers using buses will be significantly affected by the detour effort
- Walk-up passengers will be within 1/2 mile of other stations and will have remaining bus options
- Rail ride-through passengers and most of those making rail line transfers will not be affected



## Operational Changes & Customer Impacts During Construction

- No pedestrian access at street levels; contractor and emergency access/egress only.
- Concourse Level (faregates) will be closed
  - No patron restrooms; employee restroom near Marble Room on outer East Platform
  - No elevator access from N/S to E/W Platform levels; must ride to adjacent station(s) and return on opposite direction to access other platform
- Transfers for rail service between platforms will not be affected.
- Closure to plaza/concourse is planned for 18 months, duration will be refined as design progresses.
- Accommodations will be made to reopen the plaza/concourse access during the World Cup.
- Construction will continue through 2028.



# Ashby Station Relocation

MARTA Police Central Precinct (west line) – coverage maintained in station ●

Lost and Found ●  
Reduced Fare ●

Ride Store ●  
MARTA HOPE ●

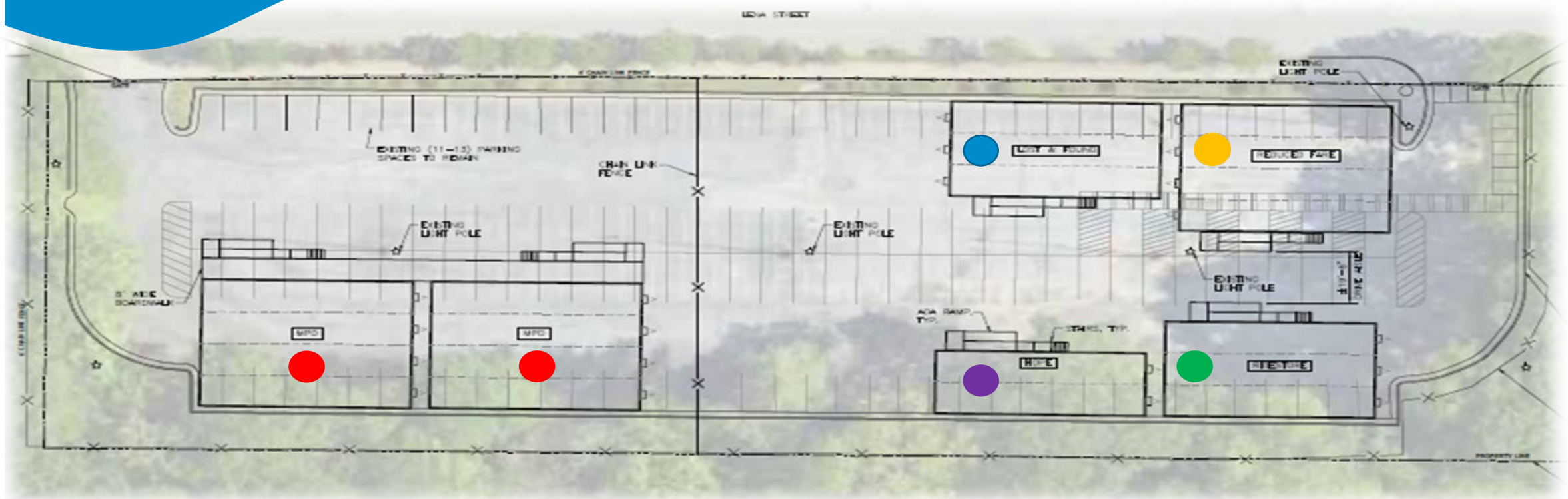

**Closing During  
Construction**

FIVE POINTS FARM

A MARTA MAKEOVER COMMUNITY GARDEN

marta<sup>®</sup>  
market



**Station  
Soccer<sup>®</sup>**  
*Atlanta*

Connecting communities through transit, soccer, and leadership training.



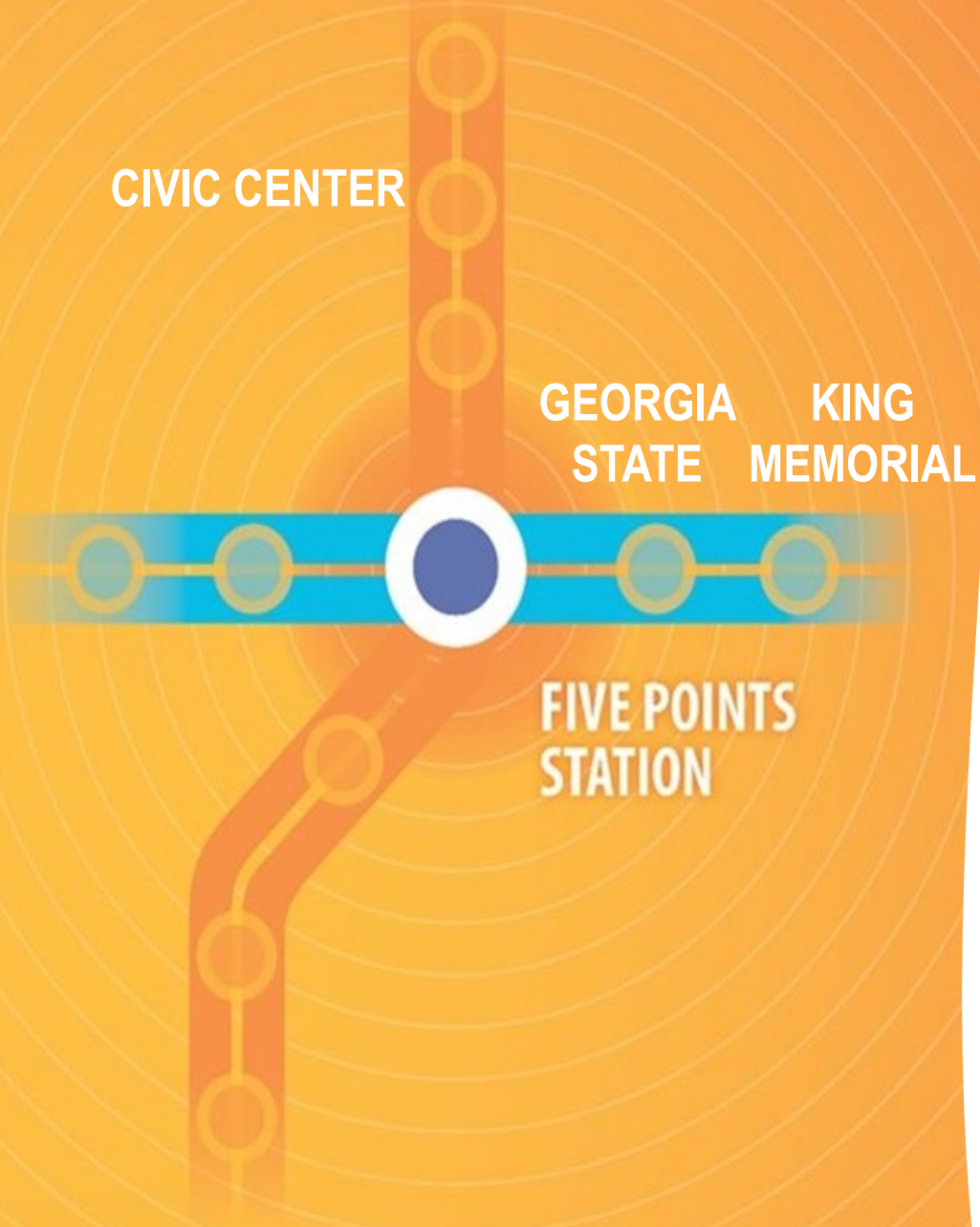

| Rail Station         | Bus Routes Detoured  |
|----------------------|--|
| <b>Georgia State</b> | 21 – Memorial Dr<br>42 – Pryor Rd<br>49 – McDonough Blvd<br>55 – Jonesboro Rd<br>186 – Rainbow Dr/South DeKalb |
| <b>King Memorial</b> | 26 – Marietta St/Perry Blvd<br>899 – Old Fourth Ward   |
| <b>Civic Center</b>  | 816 – North Highland Ave   |

|   |   |
|---|---|
| <b>Through-Routed to Maintain Service in Five Points Area</b> | Route 3 – Martin Luther King Jr Dr/Auburn Ave<br>Route 40 – Peachtree St/ Downtown<br>Route 813 – Atlanta University Center |
|---|---|

# Detour Routes to Georgia State

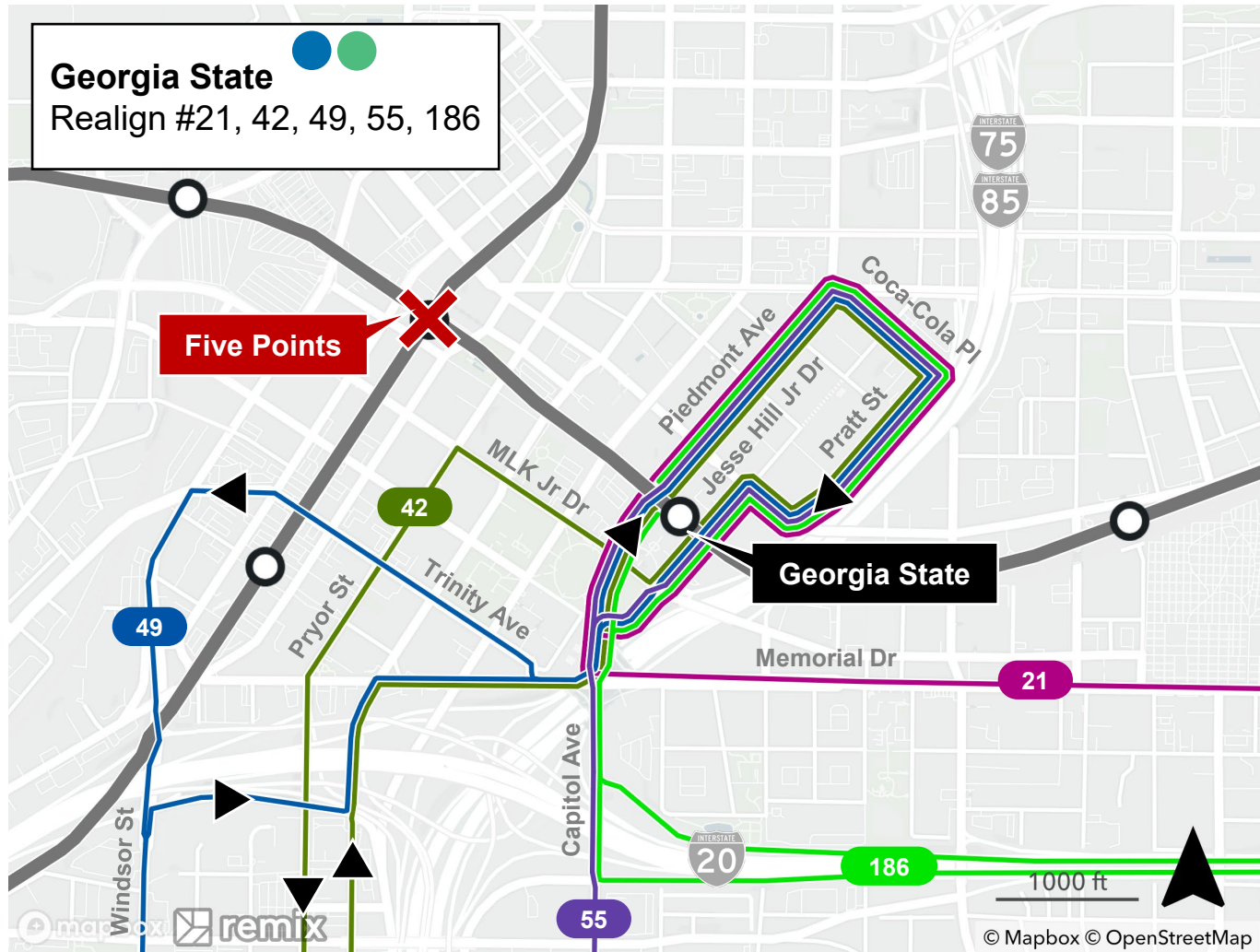

- Realign the following routes to Georgia State Station
  - 21 – Memorial Dr
  - 42 – Pryor Rd
  - 49 – McDonough Blvd
  - 55 – Jonesboro Rd
  - 186 – Rainbow Dr/South DeKalb
- Operational and Customer Experience challenges at the station will be addressed



# Detour Routes to Georgia State

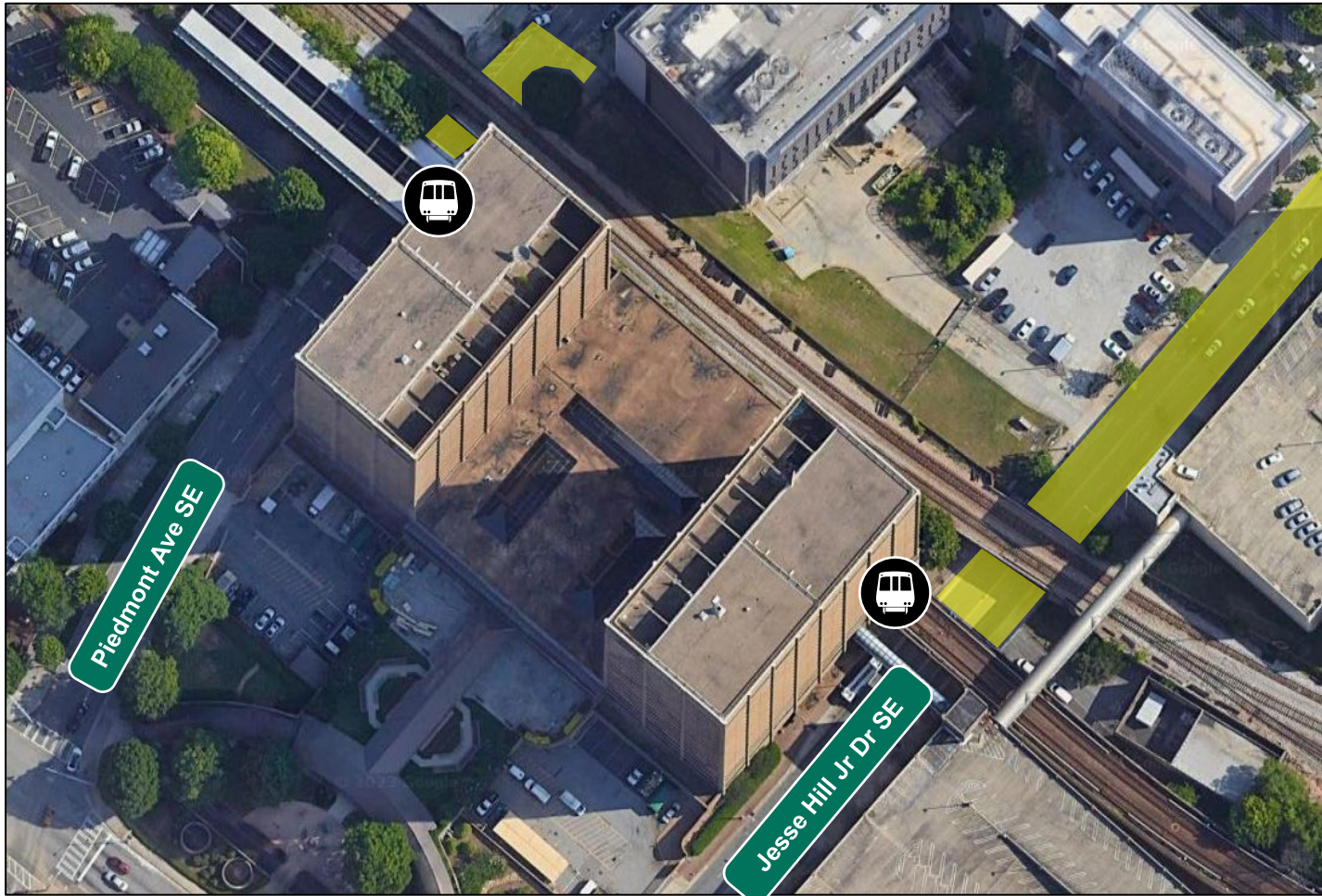

- **Temporary bus stop zones** to be added on Piedmont Ave and Jesse Hill Jr Dr
- Additional layover-only space will be added on Jesse Hill Jr Dr
- On Piedmont Ave, we will be converting no parking areas to **dedicated parking for MARTA fleet vehicles**



Rail station entrance



Detoured bus operations to be relocated to these areas



# Detour Routes to Georgia State On-Street Accommodations

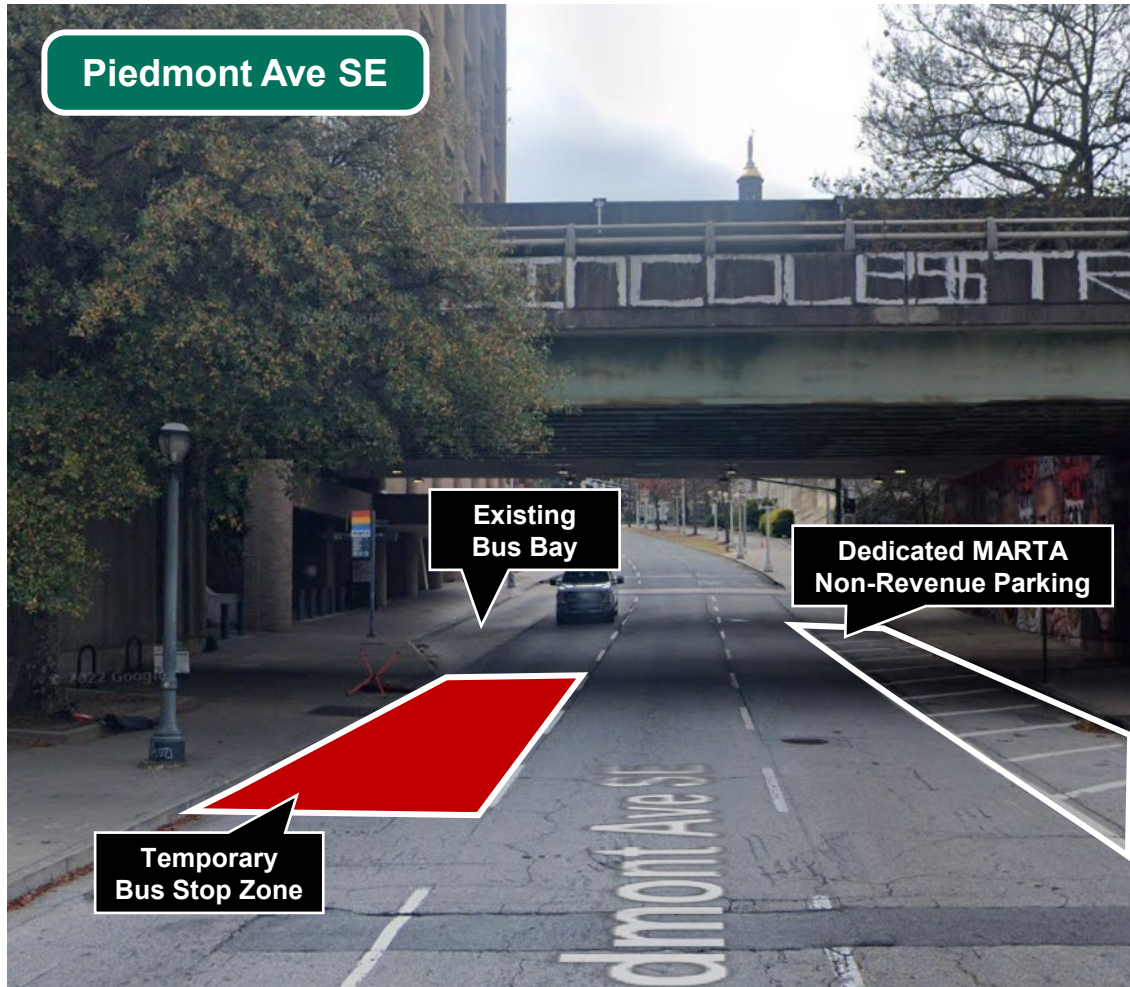



# Detour Routes to Georgia State On-Street Accommodations

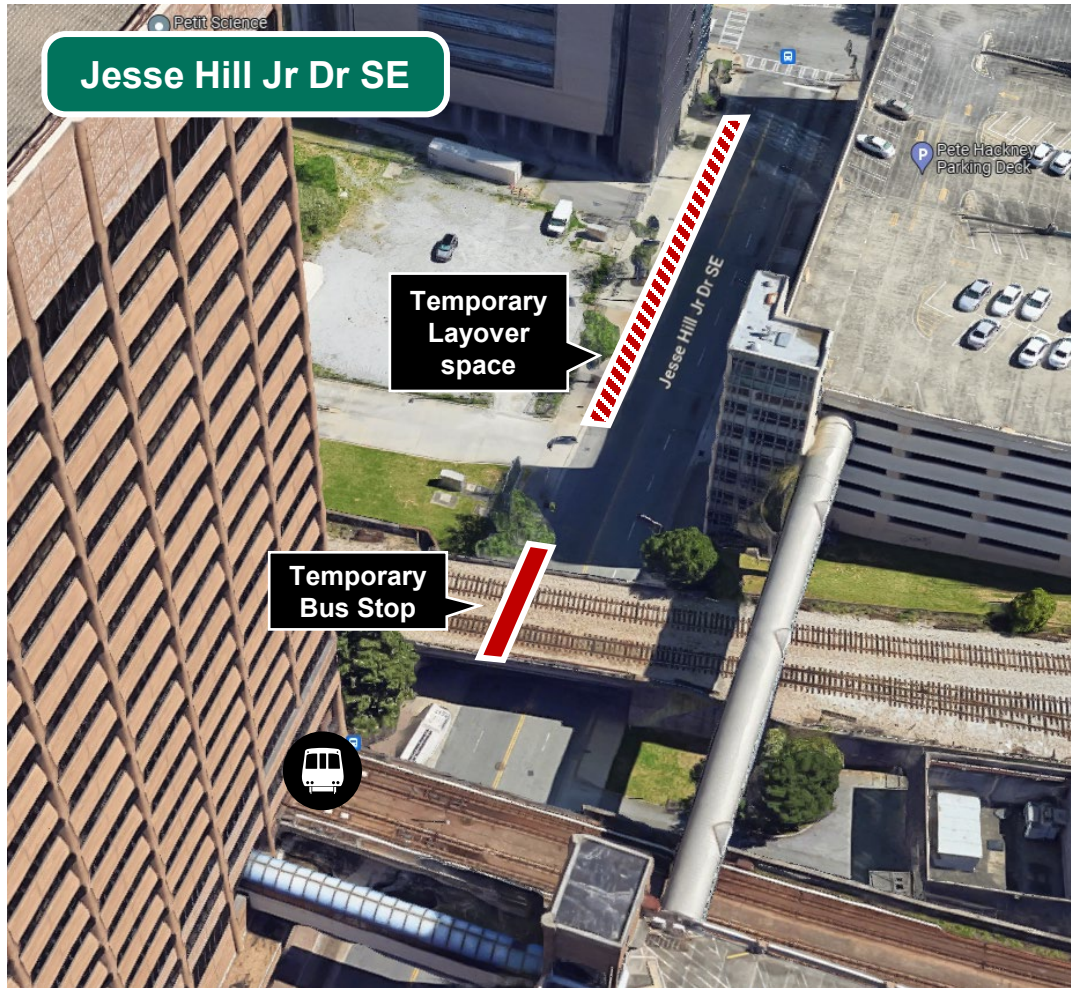

- On Jesse Hill Jr Dr, a **temporary bus stop** to be added under the freight railroad bridge
- Additional **layover-only space** to be established along Jesse Hill Jr Dr, clear of the GSU Petit Science Center service driveway



Rail station entrance

# Detour Routes to King Memorial



- Realign the following routes to King Memorial Station
  - 26 – Marietta St/Perry Blvd
  - 899 – Old Fourth Ward
- Does not require additional on-street accommodations



# Detour Service to Civic Center

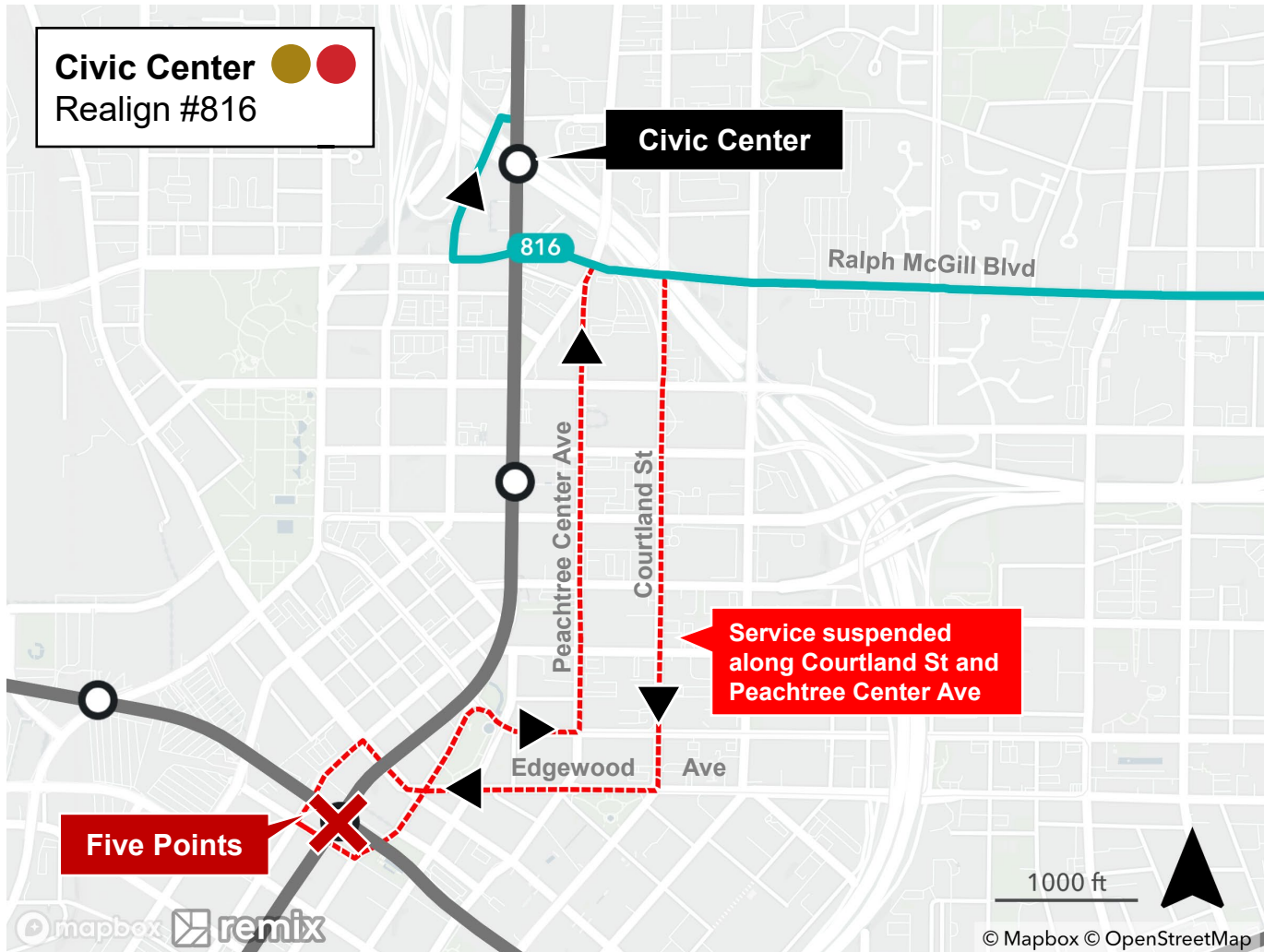

- Realign the following route to Civic Center Station
  - 816 – North Highland Ave
- Does not require additional on-street accommodations
- Service suspended along Courtland St and Peachtree Center Ave, though closed stops will remain within walking distance of other service

# Maintain Five Points Area Access by Through-Routing

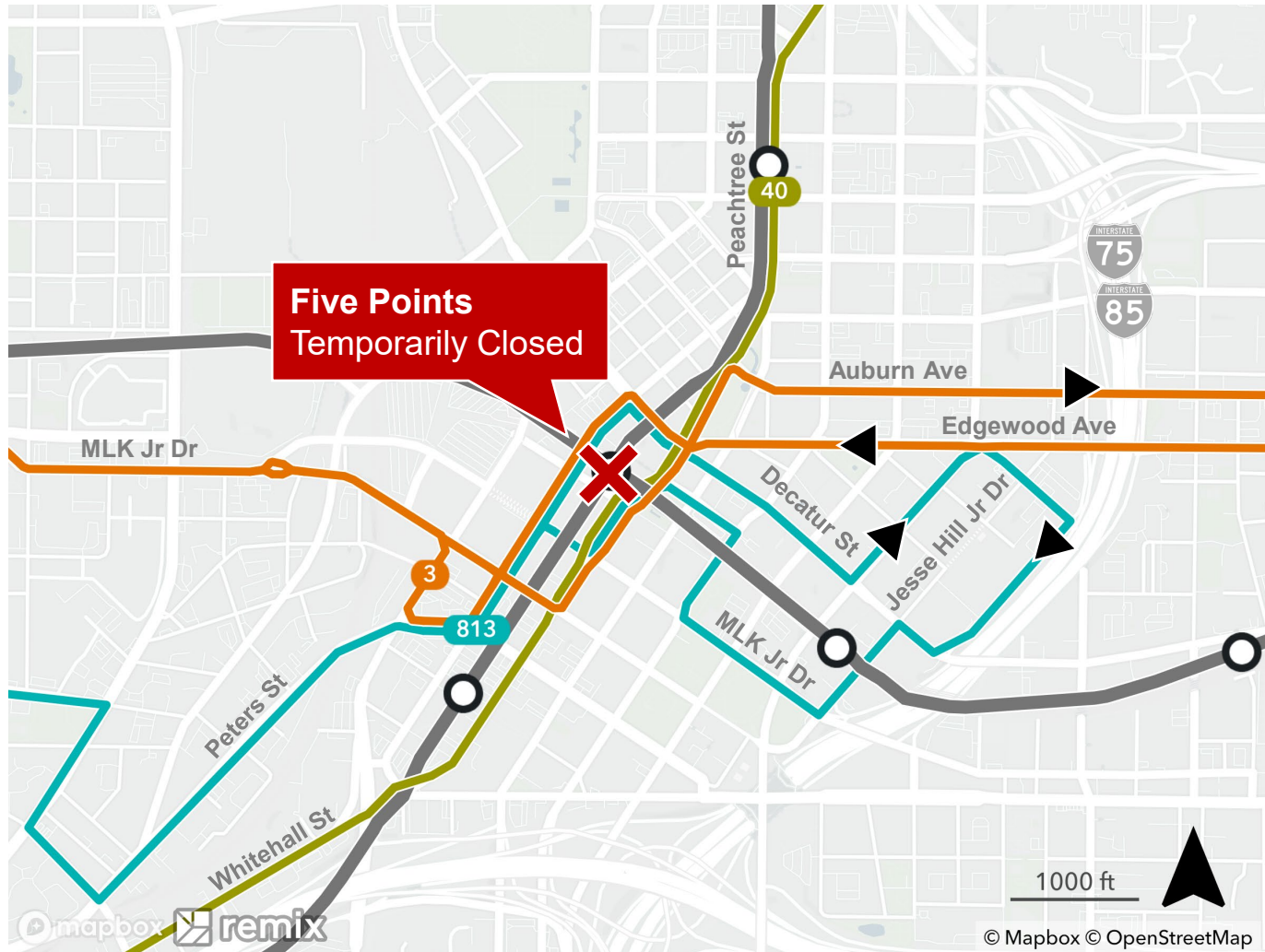

- Five Points Station area is within ½ mile (10-minute walk) of other stations
- Three bus routes will continue to operate through the area during the station closure

- Route 3 – Martin Luther King Jr Dr/Auburn Ave
- Route 40 – Peachtree St/ Downtown
- Route 813 – Atlanta University Center

# Five Points Transformation – ADA Rail Line Transfer Shuttle

## SERVICE PLAN

Daily Service Hours: 22

Headway: Approx. -5 Mins or Load n' Go

Runtime: 10 Minutes Roundtrip

Route Miles: 2.33

Daily Buses needed: 3

*This Alignment will connect **Georgia State Station** to **Peachtree Center Station** to accommodate North / South to East / West Transfers for non-ambulatory customers*

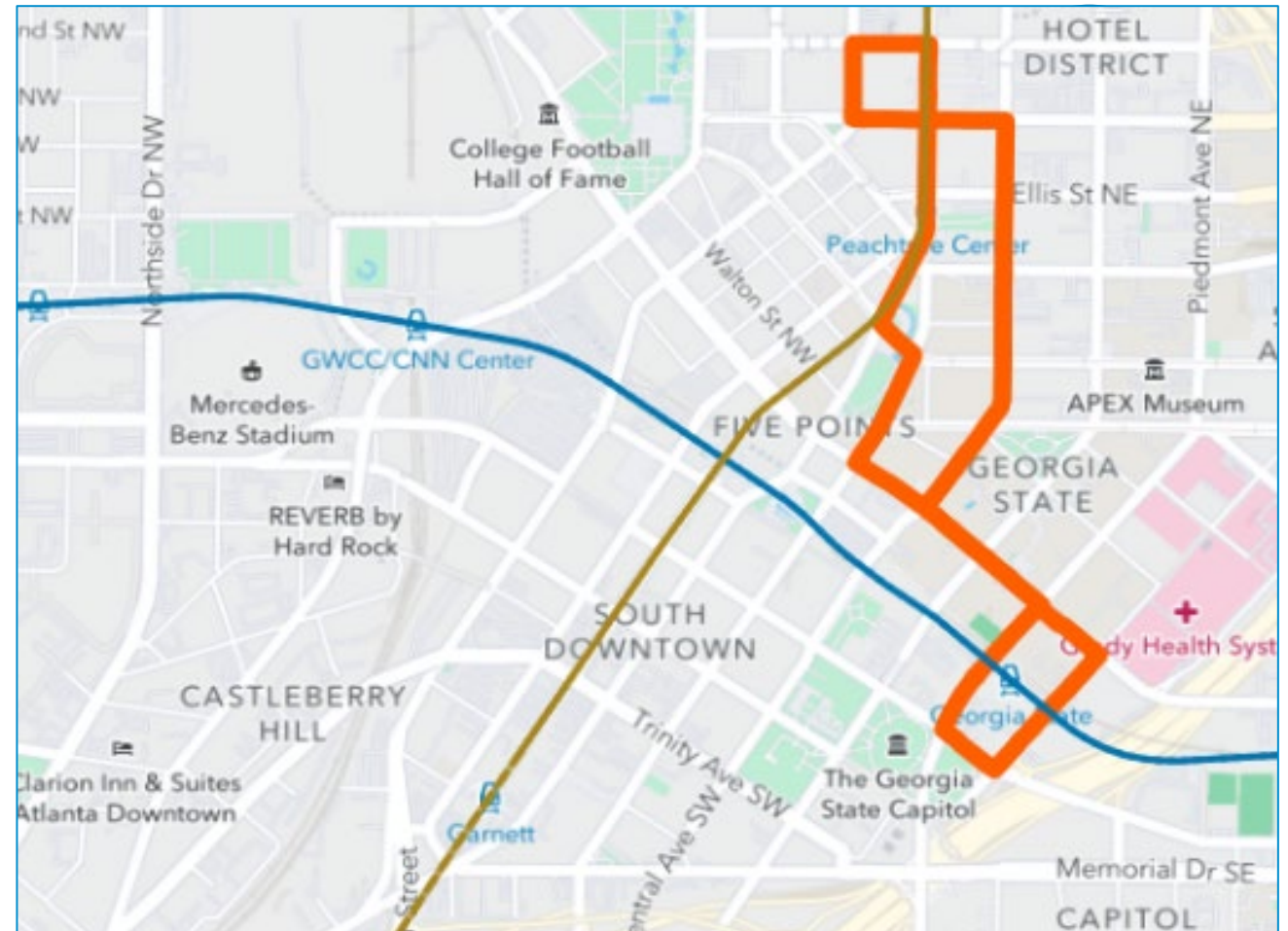



## Construction Contract – CMAR Delivery

- Skanska USA Building Inc, currently is performing preconstruction services during design of the Five Points Station.
- These services are in conjunction with SOM (designer) to provide detail plans and designs to deconstruct, demolish, and build back a new canopy structure at the Five Points Station.
- Currently, deconstruction and demolition are planned to start in June 2024. Once, the remaining design packages are complete, Skanska will be able to progress to the transformation phase of construction.



## Deconstruction Major Tasks

- Advertise forthcoming station entrance closure and construction.
- Secure construction area with fencing.
- Close entrance of station.
- Isolate concourse and plaza level power from platforms.
- Close Alabama Street (south face of station) to service as a staging area.
- Engineer removal of existing post tension concrete structure.
- Maintain existing waterproofing.



***Before deconstruction will start, all services provided by the Authority- Hope Office, Lost and Found, Reduced Fare, Ride Store, and Police - will be relocated to a temporary compound at Ashby Station West parking lot.***

## Demolition Major Tasks

- Relocate, cap and seal existing fire protection system to only service the platforms.
- Remove existing furniture.
- Remove existing escalators.
- Clear vegetation and concrete off site.





# Deconstruction / Demolition Schedule

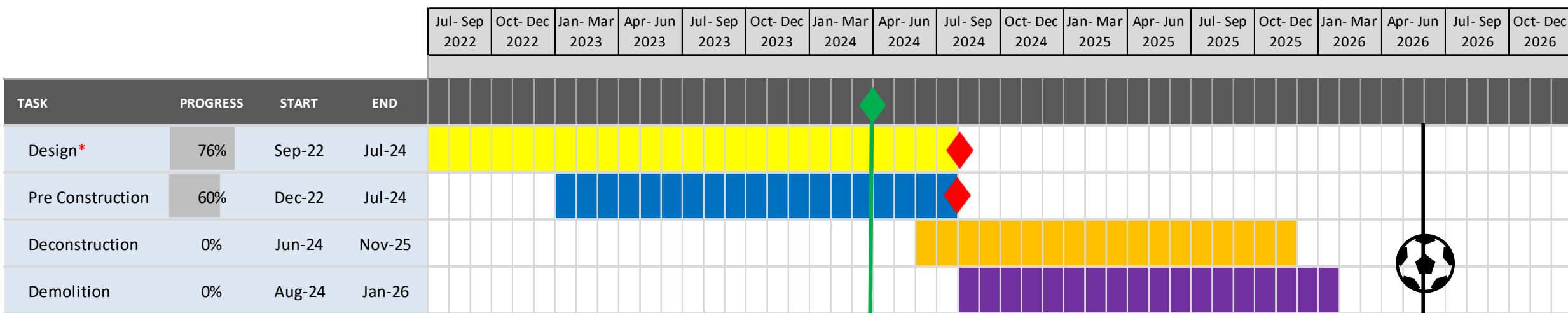

**\*Design:**

- Deconstruction and Demolition at 100%
- Build Back at 60%

**Future Construction**

- Civil
- Vertical Transportation
- Transformation (Canopy)

## Next Steps

- Received revised proposal from Skanska, under review.
- Future resolution to approve the Authorization of funding for Deconstruction of the existing canopy and Demolition of select infrastructure inside the station. ***Will return to the Board once the cost and DBE percentages have been finalized with Skanska.***

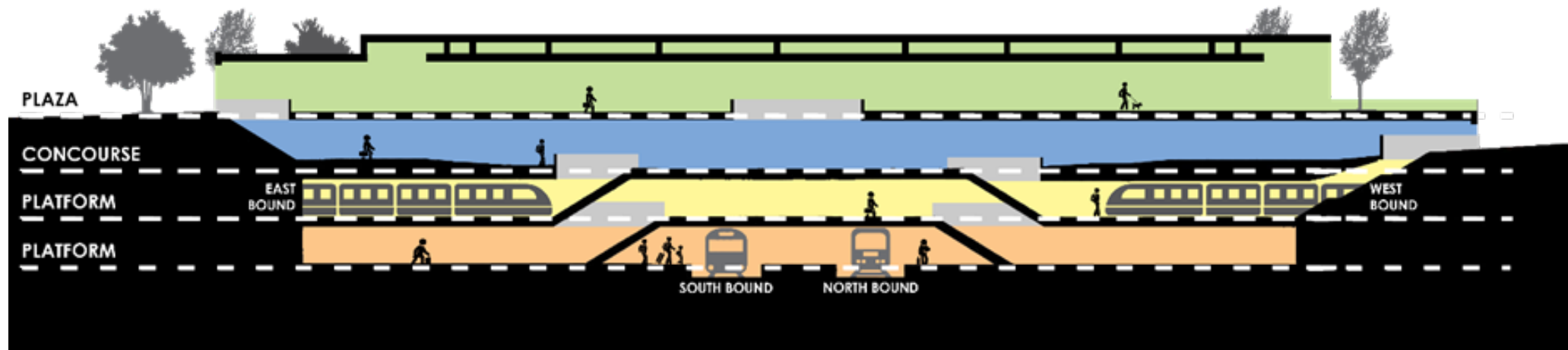



**Thank You**



# INFILL STATIONS

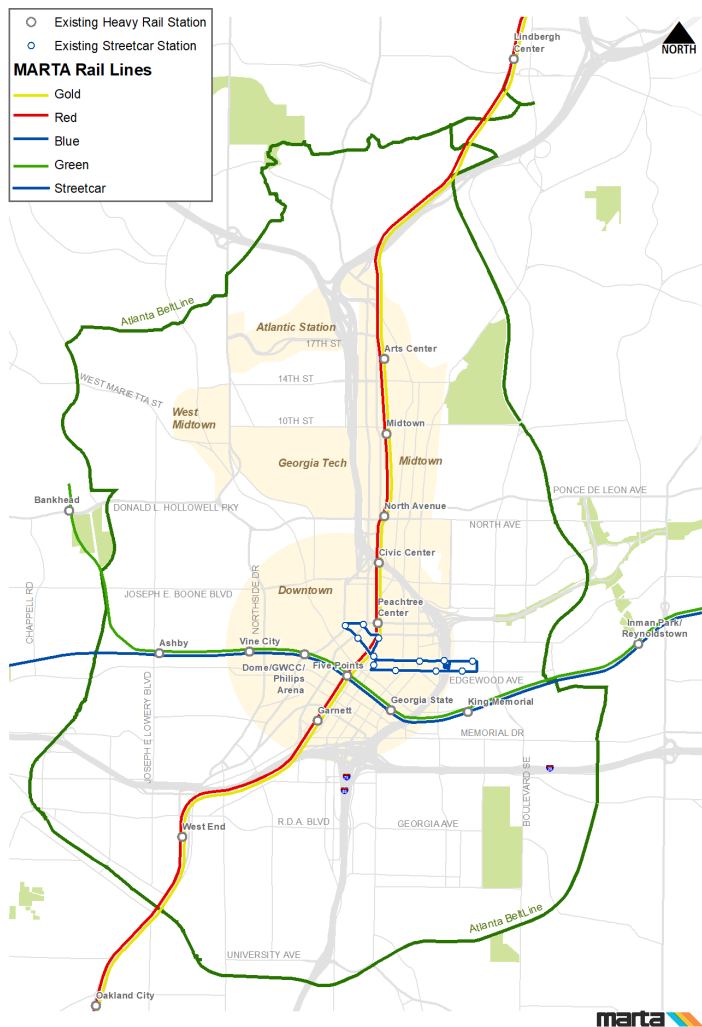

Proposed Murphy Crossing infill station location



# STREETCAR EAST EXTENSION

Work on this project is focused on two areas of study:

- The feasibility and cost for replacing wired streetcars with smaller, electric, off-catenary wire trains.
- How to improve the efficiency and experience of the existing streetcar.

